



Unbridled

Unbridled



Welcome aboard





Breakfast on the bridge deck





Buttermilk pancakes with maple syrup and banana

Mango & blackcurrant puree with yogurt with fresh mint

Freshly squeezed juices & fruit infused purified water from the yacht's own on-tap pure drinking water system

Handmade pastries - traditional croissants, chocolate, pecan and spice twists



French toast with organic berries, maple syrup and mascarpone



Morning chill-out on the sun deck









Melon & blackberry skewers
Lime, kiwi fruit & cucumber detox smoothie
Carrot & ginger reviving smoothie





Playtime





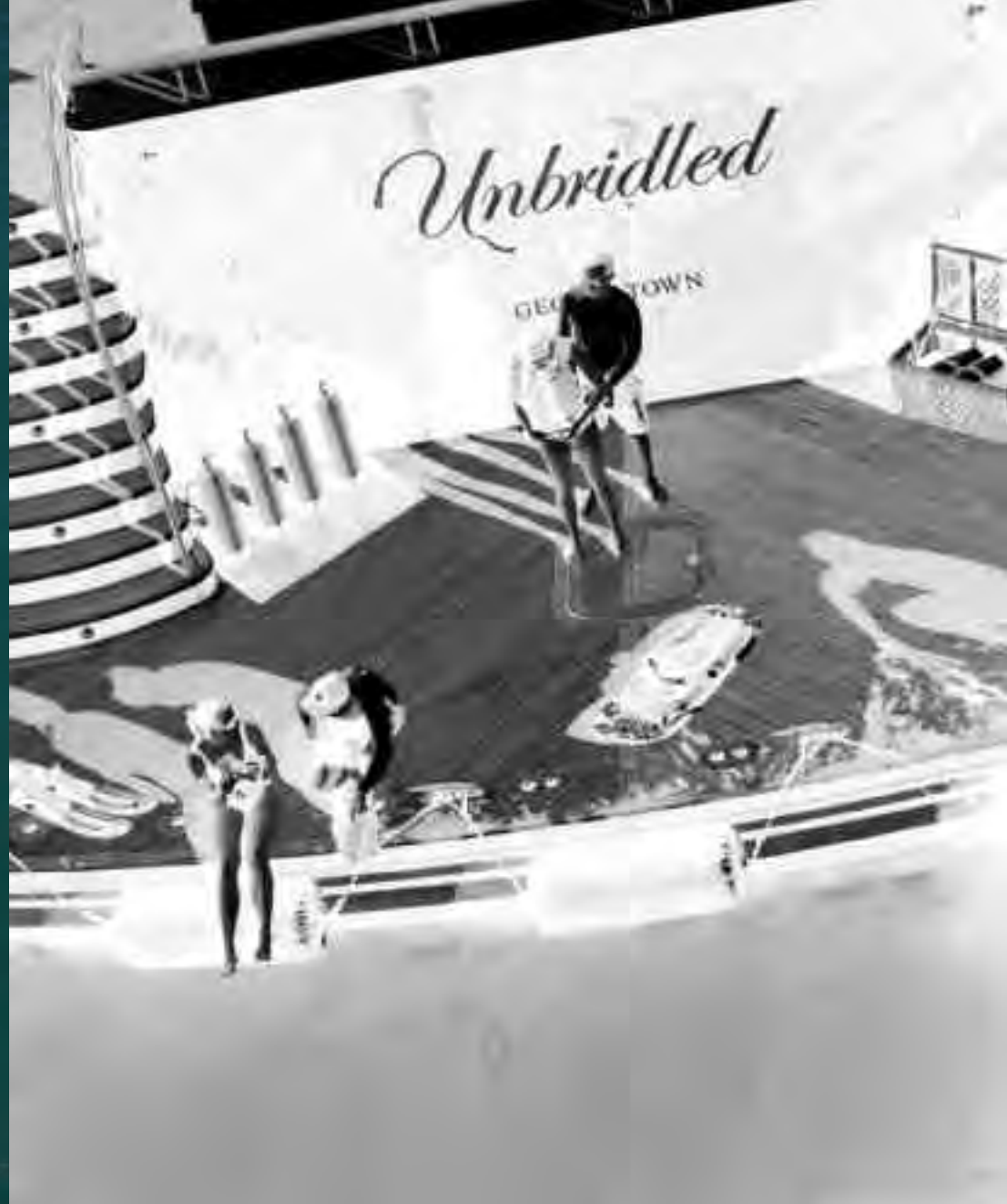





The beach party





Green mango, chilli and peanut slaw with coriander, mint and tomato

Char-grilled chorizo with lemon and rosemary

Barbecued lobster with a crispy garnish of leeks and fried onions and chilli

Char-grilled calamari with roasted red peppers, rocket and pea shoots







Luncheon is served on the bridge deck



Salad of Arctic char & dill penne pasta
Rustic Caesar salad with apple-wood smoked bacon, crostinis & parmesan crisps
Olive oil poached vine tomato tartlet with sea salt flakes & thyme
Chef's Greek salad
Home-made breads daily





An afternoon nap on the Portuguese deck







Trip ashore







Be pampered in the luxury & privacy of your cabin





Master stateroom bathroom





VIP bathroom
Twin guest suite detail
Guest suite detail
Twin guest suite

VIP suite



Sundowners & canapés



Vodka shots

Black & white sesame crusted Arctic char, shaved cucumber & pea shoots

Forks of buckwheat noodles, mango, sesame & chilli

Quatro of goat cheese spheres, cracked pepper, parsley, curry powder & sumac



Bridge deck aft





Dinner is served







Char-grilled eye fillet of wagyu beef, confit potatoes, sautéed spinach, carrot noodles & white truffle jus. Garnish of crispy fried aubergine skins.



Poached saffron & mint salsa, vanilla bean mousse, lime coconut sorbet & Persian candy floss.



Brandy & chocolates at the bar





The sky lounge









Morning coffee in the lounge







Private study on the main deck

London calling... working on board



Guest study on the lower deck





Index

Accommodations

Master stateroom	62 - 67
Master stateroom study	102
VIP suite	68 & 69
Twin guest suite	68

Deck areas

Sun deck	12 - 19 & 73
Bridge deck	06 - 09, 46 & 47, 74 & 75
Portuguese deck	48 - 51
Swim platform	25 - 31, inside back cover

Living areas

Sky lounge	88 - 93
Lounge	96 - 101
Dining area	78 - 81
Guest study	104 & 105

Specifications

SPECIFICATION

TYPE Motor Yacht - twin screw diesel yacht

FLAG Cayman Islands

DIMENSIONS

Length O.A. 58.22m (191ft)

Beam 10.67m (35ft)

Draft 3.05m (10ft)

TONNAGE

Gross 803

Net 240

YEAR BUILT 2009

BUILDER Trinity Yachts, USA

EXTERIOR & INTERIOR DESIGN

Patrick Knowles

CONSTRUCTION

Aluminium Hull & Aluminium Superstructure

CLASSIFICATION

ABS Maltese Cross A1 Yachting Service AMS; MCA LY2 Compliant

MACHINERY

MAIN ENGINES

2 x Caterpillar 3512B 2012 BHP @ 1600 RPM

SPEEDS

Cruising speed 15 knots

Max speed of 18 knots

RANGE

AT 10 KNOTS 6000 nm

GENERATORS

2 x 220 kW Caterpillar C9 @ 1800 RPM

1 x 99 kW Kilopak emergency generator

ROLL CONTROL

Quantum Zero Speed Stabilizers

AIR CONDITIONING

Individual Marine Air (Dometic) fan coil

Cooling capacity 60 tons of AC

WATER PURIFICATION SYSTEM

Seagull IV X - 2KB Accufflow drinking water on-demand system.

Clean, pure water from every water source, including showers.

COMMUNICATION EQUIPMENT

Satcom & cellular communications facilities, Wi-Fi internet access

ENTERTAINMENT

State-of-the-art audio-visual Kaleidescape on-demand system

Satellite television

CD & DVD players

iPod Aux inputs / docking stations

Entire boat iPod player

50" Plasma screen in Master Stateroom

42" Plasma screen in Master Office & Guest Study

2 x 46" LCD Screens in Sky Lounge

50" Plasma Screen in Main Salon

26" LCD Screen in Guest Cabins

42" LCD Screen on Sun Deck

X-Box 360 with various games in Guest Study

ACCOMMODATION

12 Guests in 6 cabins

12 Crew in 5 crew cabins & 1 Captain's cabin

Owner's Suite

Full width master cabin located forward on the main deck with en suite bathroom. Private study located aft of the cabin

Guest Suites

2 x Queen VIP cabins with en suite bathroom, located on lower deck

2 x Twin cabins with a double bed, single bed & Pullman berth and en suite bathroom, located on lower deck

Additional cabin with en suite bathroom, located on main deck

aft of master cabin, with the option of a double Murphy bed

or 2 Pullman berths

Dedicated guest office on lower deck

TENDERS & TOYS

9.3m Novurania tender with 360hp engine

7.5m Novurania tender with 300hp engine

2 x Yamaha waverunners

Waterskis & tows

WATERSPORTS

2 x 4.6m exercise / exploring kayaks

Hobie Bravo sailing dinghy

Snorkelling gear

Paddle board

Rendezvous Scuba Diving

JACUZZI DIP POOL

GYM EQUIPMENT

Outdoor gym equipment

Deck Plans



SUNDECK

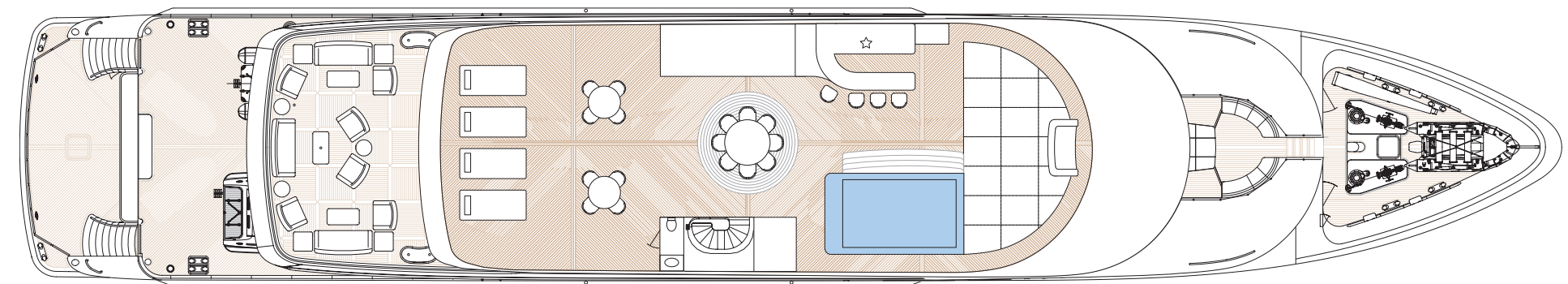

BRIDGE DECK

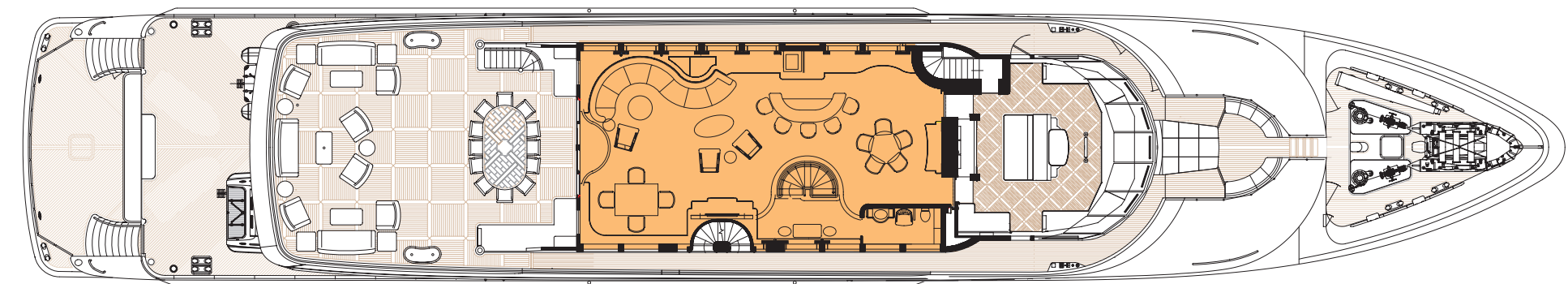

MAIN DECK

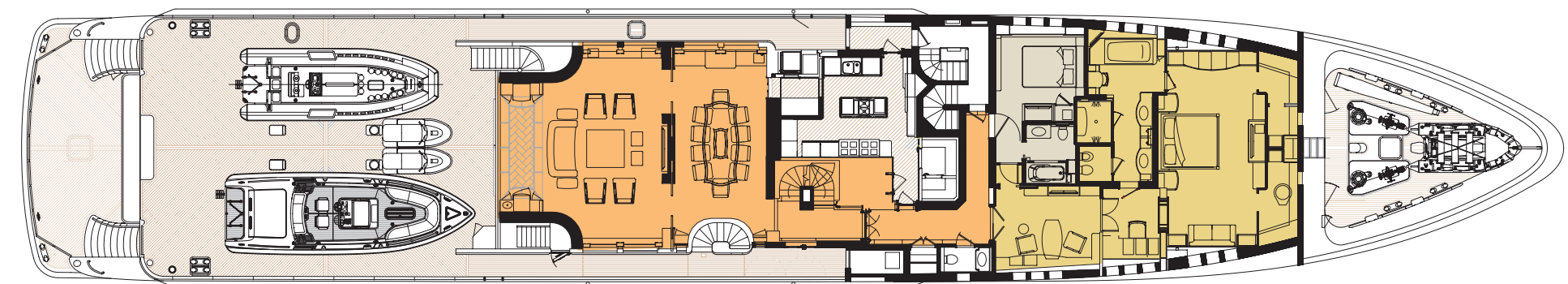

LOWER DECK





Brochure co-ordination: Burgess
Photography: Sean Gleason, Clare Booth & Dana Jinkins
Design & Production: Wilkins Productions



