

E-BROCHURE

Silver Angel







A proven charter yacht, SILVER ANGEL comes with exceptional exteriors and interiors spaces and every luxury superyacht feature imaginable.

Designed by Argent Design of London, which collaborated with the revered yacht designer Stefano Natucci, SILVER ANGEL was launched in 2009 to much acclaim and underwent a refit in 2015.







An Art Deco theme runs throughout the interiors and exteriors of SILVER ANGEL, with glossy black oak panelling complemented by Onyx and white furnishings and lots of mirrors, while white marble and silver leaf add some glamour and sparkle.









She can accommodate 12 guests across 7 cabins, including a full-beam Owner's suite on the main deck forward.

The rest of the guest accommodation is spread across a further four doubles, including a VIP cabin on the upper deck, and two twin cabins on the lower deck.

















SILVER ANGEL is a luxury superyacht that is a cut above her peers when it comes to onboard opulence and entertaining spaces.

Her features include three excellent alfresco dining areas, four bars, and an oversized swim platform; while on the sun deck, a sweep of travertine steps leading up to the mosaic counter-current pool feels very old Hollywood.



























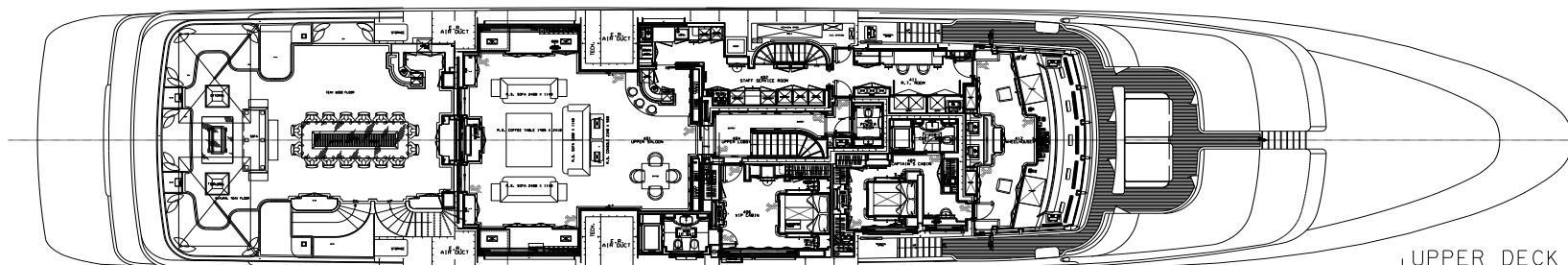
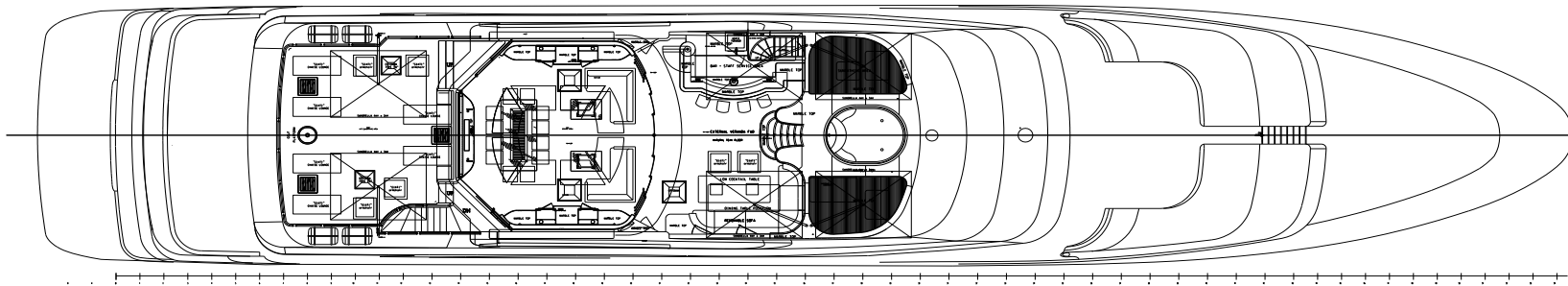

UPPER DECK

B A 0 1 2 3 4 5 6 7 8 9 10 11 12 13 14 15 16 17 18 19 20 21 22 23 24 25 26 27 28 29 30 31 32 33 34 35 36 37 38 39 40 41 42 43 44 45 46 47 48 49 50 51 52 53 54

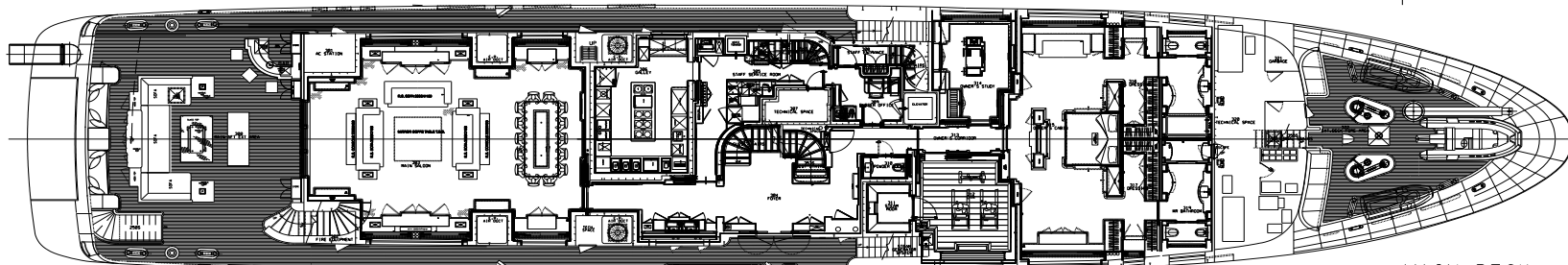

MAIN DECK

B A 0 1 2 3 4 5 6 7 8 9 10 11 12 13 14 15 16 17 18 19 20 21 22 23 24 25 26 27 28 29 30 31 32 33 34 35 36 37 38 39 40 41 42 43 44 45 46 47 48 49 50 51 52 53 54

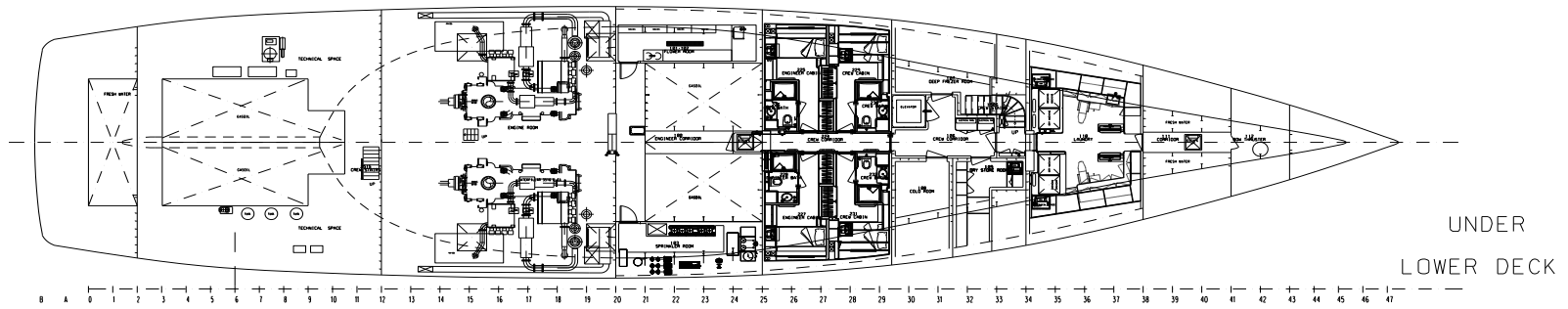
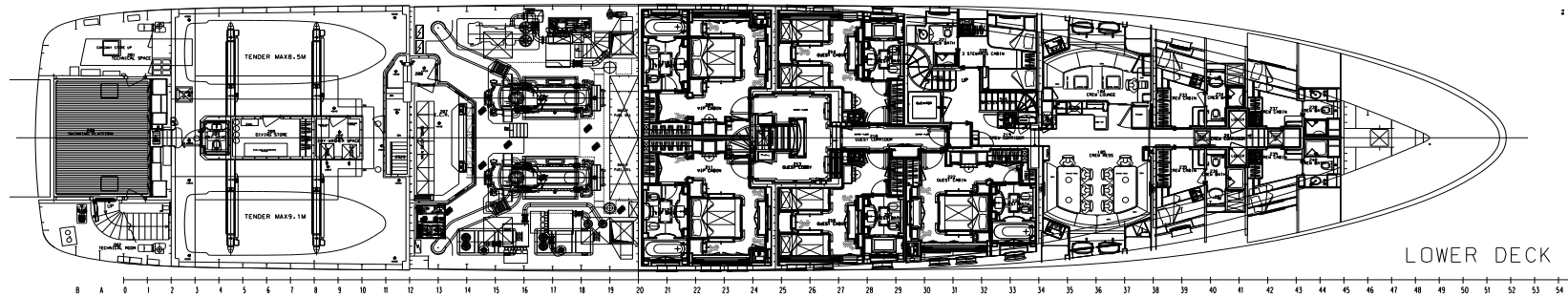



SPECIFICATIONS

MAIN CHARACTERISTICS

Builder: Benetti
LOA: 64.50 metres (211' 7")
Crew: 19
Built: 2009
Refit: 2015
Accommodation: 12 guests
Cabin configuration: 5 Double, 2 Twin
Cruising speed: 13 knots

TENDERS

2 x 7.5m Novurania semi-rigid tenders with diesel inboard stern drive

TOYS

2 x Yamaha FX high output jet skis
2 x F5S SeaBobs
3 x Inflatable paddle boards
2 x Kayaks (2 man)
1 x Kiteboard Waterskis, wakeboards & kneeboard
Inflatable water slide (from the main deck)
Aquaglide inflatable trampoline
Aquaglide inflatable pyramid
Aquaglide inflatable climbing wall
1 x Sofa (3 man)
2 x Small sofas
1 x Biscuit
2 x Donuts
1 x Banana (5 man)
1 x Alligator (3 children)
1 x Inflatable zorb ball
Deep-sea fishing tackle fishing rods
Light tackle fishing rods
Diving 12 x diving equipment & Bauer dive compressor
Snorkelling gear
Wetsuits (20 x full, 20 x short)

GYM EQUIPMENT

1 x Technogym elliptical trainer
1 x Technogym kinetics machine
1 x Exercise bench
1 x Peloton exercise bicycle (guests to bring their own shoes)
Selection of weights
Yoga mats

SPA

Massage room and on-board massage therapist (qualified Somatologist)
Hamam (steam room)

KEY FEATURES

Extraordinary exterior decks with plush lounge areas and sociable al fresco dining
Spa with hamam and massage room and a dedicated onboard masseuse
Fully equipped gym
Elegant Art Deco interior design with glossy black oak panelling, white Onyx furniture, white marble and silver leaf
Sun deck with sweeping travertine steps which lead up to a beautiful mosaic counter-current pool
Array of water toys including scuba diving gear, a waterslide and jet skis

*Photoshoot planned end of October 2023

Advertising of the above vessel in either printed publications on the internet or in any other medium is not permitted without prior permission from the Owner via the Central Agent.

All particulars are given in good faith and are believed to be correct but cannot be guaranteed.