

E-BROCHURE

Rosehearty







A Perini Navi Cup Winner, Rosehearty is ready for adventure and offers an unforgettable sailing experience in the world's most remote destinations.

Her white hull and black tinted wraparound windows cut a sharp shape of luxury – a combination of long lean lines, smooth curves and muscular power.









Her interior is one of the rare yacht designs by Christian Liaigre with crisp white linen sofas, Hermes leather, pale oak and ebony.

ROSEHEARTY can accommodate up to 12 guests in seven spectacularly stylish cabins, including a full beam master suite, two VIP cabins, three double cabins, one of which is located on the Main Deck, and a twin cabin.





Guests can dine on deck in the cockpit that converts to an outdoor cinema, or during the day, enjoy an exquisite lunch on the flybridge.

Dining tables and sofas are set in front of the Jacuzzi and sunbathing area.



FLY BRIDGE

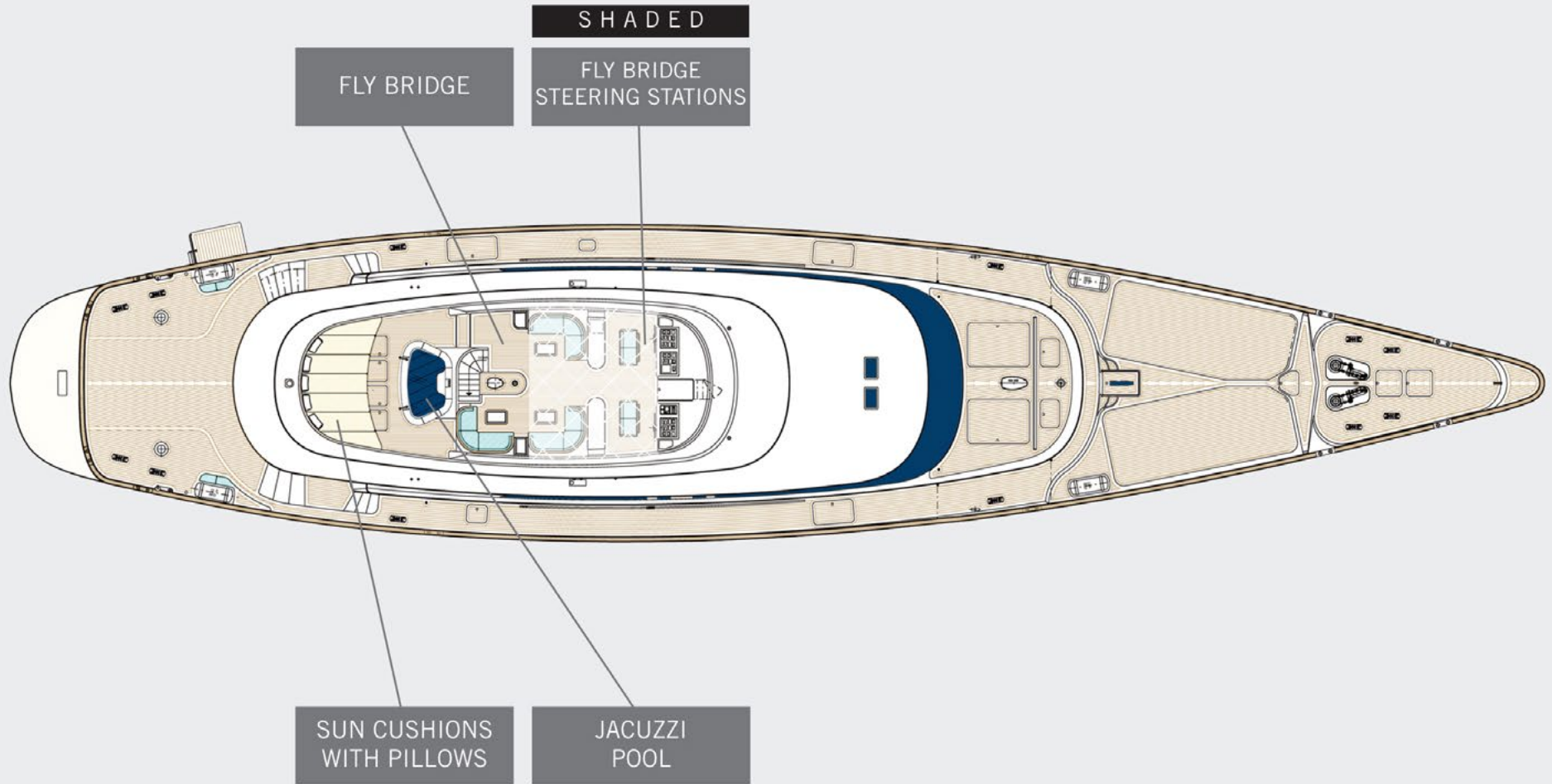

MAIN DECK

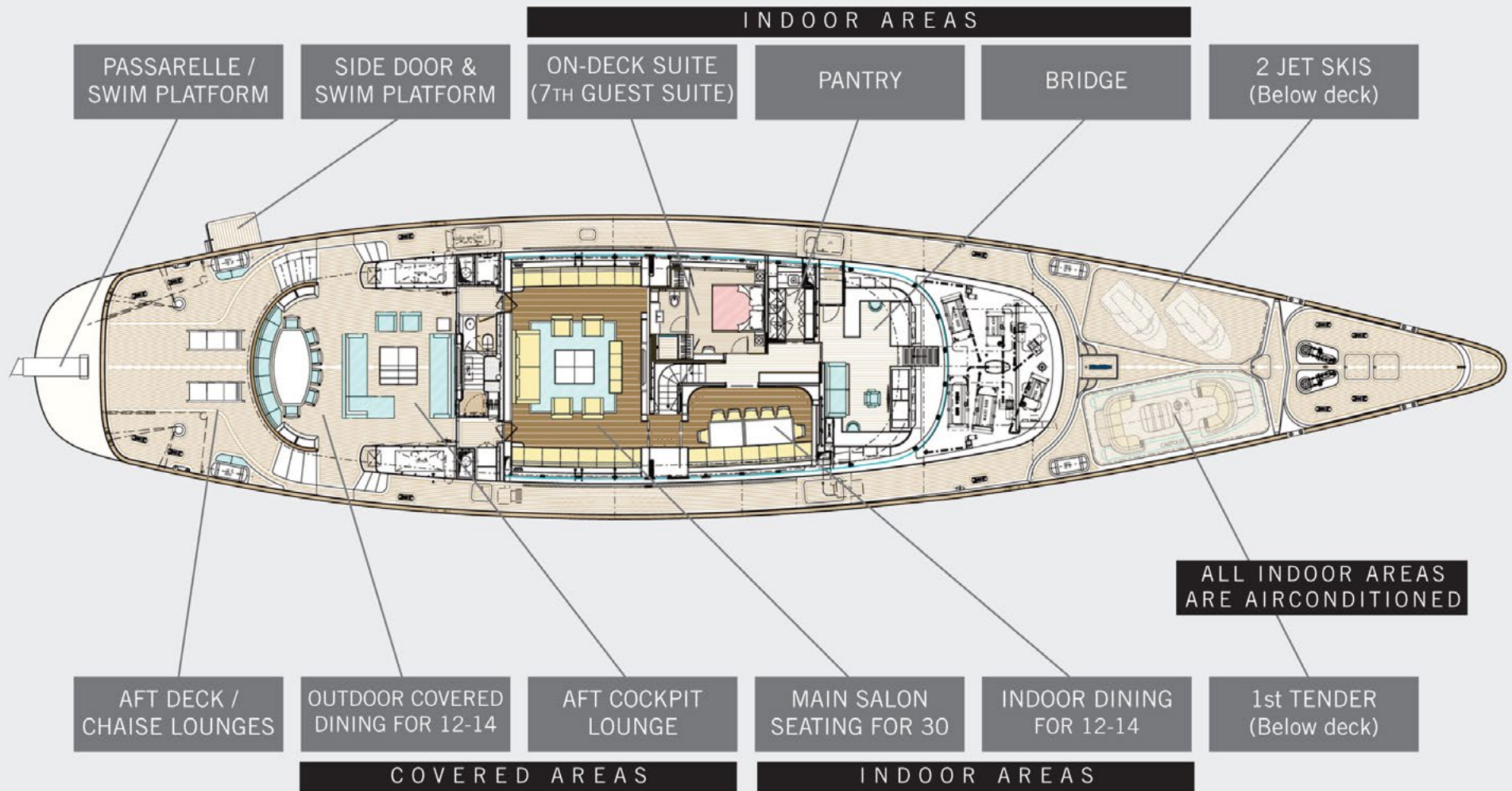

LOWER DECK

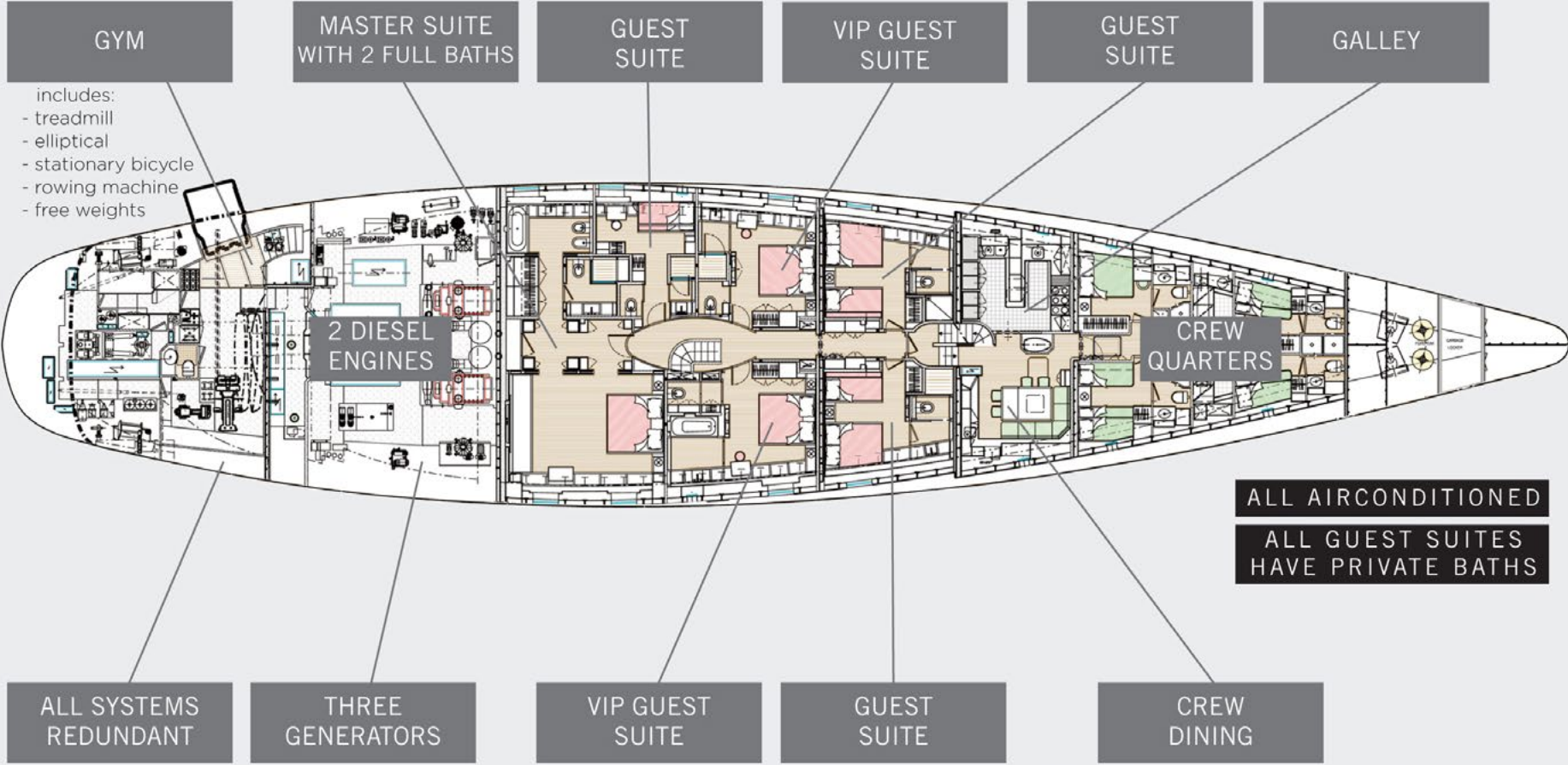



SPECIFICATIONS

MAIN CHARACTERISTICS

Builder: Perini Navi
 LOA: 56m (184')
 Crew: 12
 Built: 2006
 Refit: 2020
 Accommodation: 12 guests
 Cabin configuration: 1 King, 3 Queen, 2 Double,
 4 Single, 2 Pullman
 Speed: 13 knots

TENDER

37' Hinckley Picnic Boat "Panthera" (weather dependent)
 20' Nouvarania tender. Inboard. 260HP

TOYS

4 x Aquaglide inflatable kayaks

2 x Jet-skis*
 Seadoo GTI 130. 3 persons
 Seadoo Wake Pro

4 x SUPs by Red Paddle Co.
 1 x 12'6" Explorer. 2016
 1 x 10'8" Ride. 2016
 2 x 12'6" Sport. 2018

4 x Seabobs
 1 x Cayago VX2. Yellow 2008
 1 x F5 Yellow 2015
 2 x F5S. Red and silver 2015

Flyboard. 'Zapata FB03000'. Used with jet-ski. 2014

2 x Waterskis
 1 x O'Brien Performance skis. 1.7m
 Foot size: Men's 7-13 – fits nearly all foot sizes
 1 x set of child's water-skis

3 x Wakeboards
 144cm Jobe Conflict blue wakeboard
 O'Brien 140cm
 Small Wakeboard. 133cm

6x Full sets of Mares Dive gear. (RDV Diving Only)
 BCD's (2x) XL, (2x) L, (2x) M
 Wetsuits – long-sleeve and short-sleeve
 (Majority are 2.5mm)
 Boots and Gloves. All sizes.

Towables

3-Person Jobe Banana
 3-Person Jobe Couch

FEATURES

Only Perini Navi sailing yacht with 7 cabins for up to 12 guests

Spectacular interior design by Christian Liaigre

Magnificent 37' Hinckley Picnic Tender

Highly professional and experienced long-term Captain and Crew

Winner Perini Navi Cup and St. Barths Bucket

Excellent references and many repeat charter clients

Extensive toy list

*Note: Rosehearty carries either the Jet-skis or 7.0m MilPro on board at any one time

