

E-BROCHURE

Rio









Delivered in 2022 by CRN Ancona, RIO is a 62m tri-deck superyacht combining space, privacy and considered design. Her layout flows naturally between sociable and secluded areas, ideal for families and mixed groups. A private Owner's deck, wellness centre and beach club create a relaxed, contemporary setting for effortless time onboard.





Interiors by Pulina Design combine clean lines with carefully selected materials. A calm palette of whites and warm woods is lifted by subtle colour through artwork and soft furnishings. Large windows enhance natural light and space, while tactile finishes and a striking Azul Macaubas bar define the main salon.





Interior spaces are designed for both socialising and relaxation. The main deck features a spacious salon with bar and formal dining, complemented by a quieter forward lounge. On the lower deck, a dedicated wellness area includes a beach club with hammam, steam shower and massage space, while a separate gym is located within the guest accommodation area. A lift connects all guest decks.







RIO



RIO accommodates up to 12 guests across six ensuite cabins, offering privacy and flexibility. Three principal suites include a full-beam Owner's suite with private terrace and jacuzzi, a main deck VIP and a lower deck VIP. The remaining accommodation includes two doubles, a twin with a Pullman and a staff cabin for a nanny or security.













Exterior spaces onboard RIO are designed for relaxed, open-air living. The bridge deck features a pool, sun pads, bar and lounge, while the Owner's deck offers private dining and a terrace with jacuzzi. On the lower deck, a spacious beach club with wellness facilities creates a direct connection to the water.









PROFILE

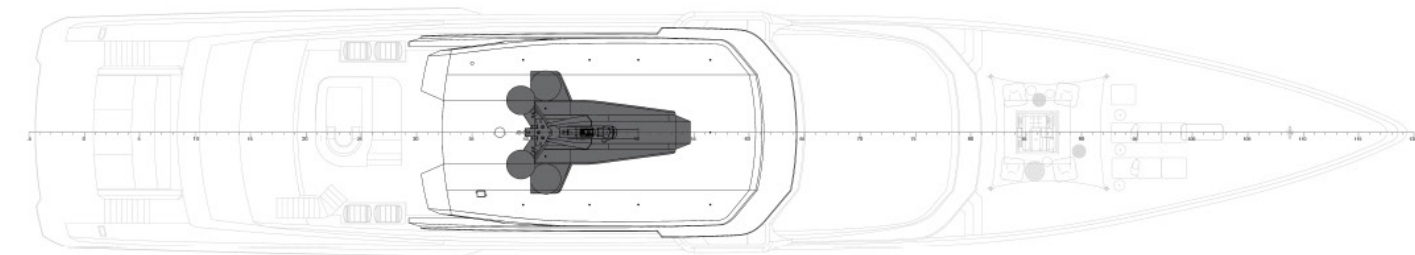

TOP VIEW

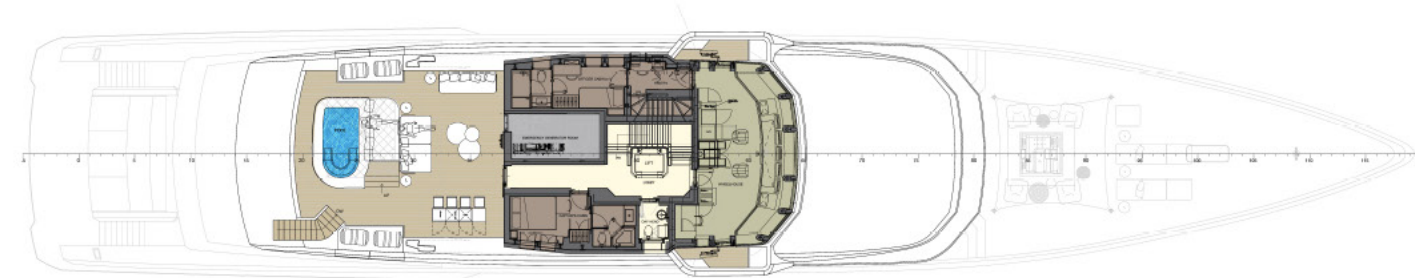

WHEELHOUSE DECK



OWNER'S DECK

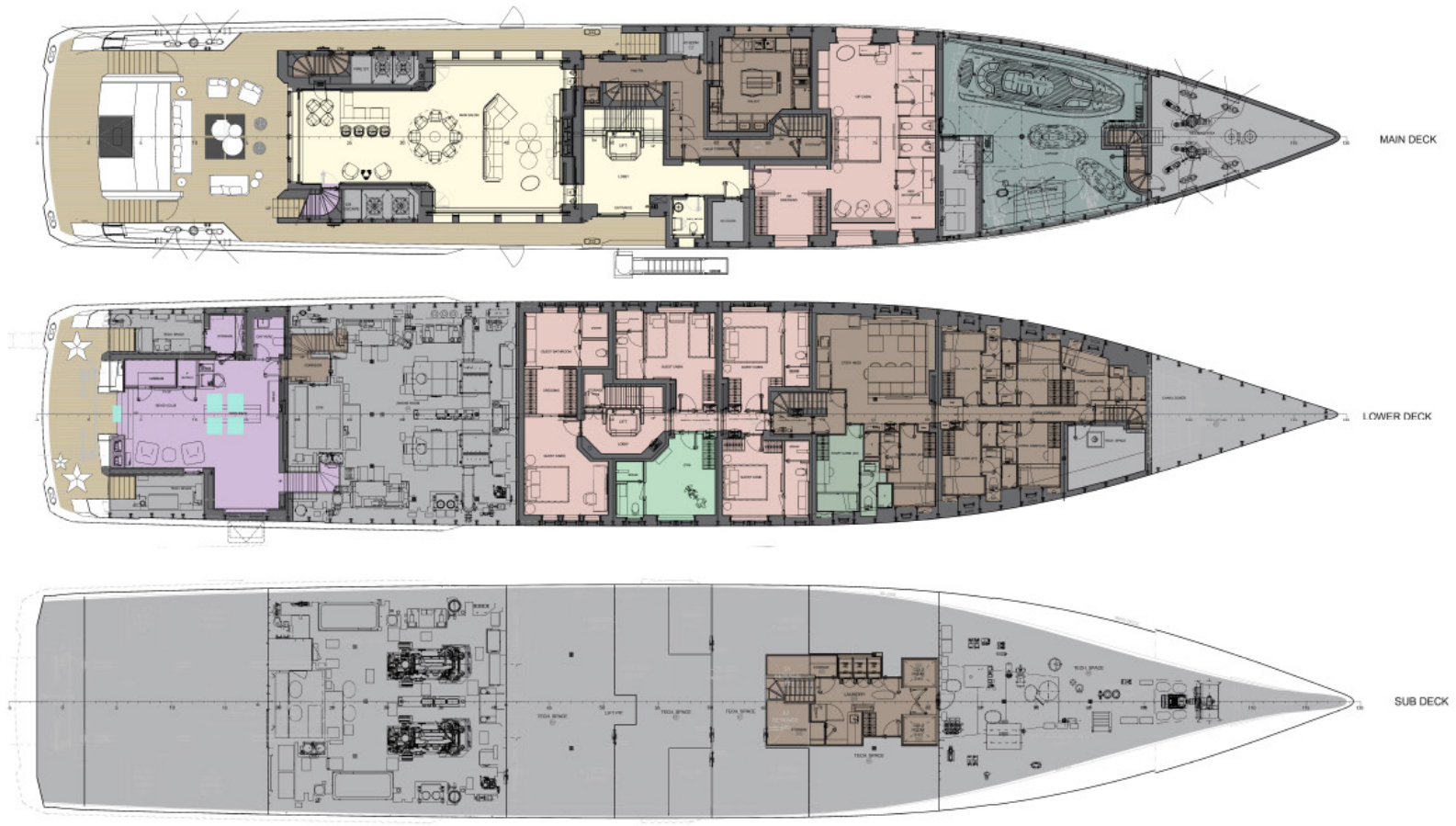

- TECHNICAL SPACE
- GARAGE AREA
- CREW AREA
- STAFF CABINS
- BEACH AREA
- WHEELHOUSE AREA
- GUEST CABINS
- GYM
- VIP AREA
- OWNER AREA



SPECIFICATIONS

MAIN CHARACTERISTICS

Builder: CRN Arona

LOA: 62m (203'4")

Crew: 16

Built: 2022

Accommodation: 12 guests

Cabin configuration: 5 double, 2 twin

Cruising speed: 12 knots

TENDERS

Chase tender – new purchase. Model TBC

1 x 8.00m / 26' Pascoe beachlander - 12 guests total

1 x 5.00m / 16' Rescue tender

GYM EQUIPMENT

The list of equipment is being updated

WATER SPORTS

3 x Seabobs - Cayago F5S-SR

1 x Sea-Doo Wakepro

1 x Sea-Doo Spark Trixx

2 x Carbon fibre flightboard Pro

1 x Flightboard Air

1 x Inflatable flight scooter (flight board with handlebars)

2 x Inflatable kayaks (2 pax)

1 x Inflatable kayak (3 pax)

Waterskis / wakeboards

Inflatable towing donuts

Inflatable 3-person towable

Inflatable stern pool

Inflatable climbing pyramid

DIVING

Scuba dive centre for 5 x guests and 1 x instructor

Snorkelling gear

FISHING

2 x Deep sea fishing rods

8 x Normal fishing rods

OTHER

2 x Foldable electric bikes

KEY FEATURES

Fun, eye-catching design. Ideal for family and friends

1 x Primary cabin + 2 x comparable VIPs to accommodate three primaries

Chase tender

Onboard masseuse

Beach club features massage area, hammam and steam shower

Massive, striking bow features secondary jacuzzi and lounge area

Elevator serving all decks

Gymnasium

Extensive list of toys

Returning crew with great charter experience

Outdoor cinema on the bridge deck

Sundeck pool

Advertising of the above vessel in either printed publications on the internet or in any other medium is not permitted without prior permission from the Owner via the Central Agent.

All particulars are given in good faith and are believed to be correct but cannot be guaranteed.