





A FLOATING MASTERPIECE

Ocean Emerald combines luxury, contemporary design and cruising perfection for the ultimate yachting experience.

A spectacular 41 meter super yacht, imagined by architect Norman Foster and built by renowned Italian shipyard Rodriguez Yachts in 2009, Ocean Emerald was conceived for smooth yachting, elegant living and modern comfort.





INDULGE YOUR DREAMS

The ultimate home and playground whilst at sea...

Ocean Emerald is the perfect platform for a romantic getaway, an adventure family vacation or entertaining friends and guests.

Ocean Emerald has a choice of outdoor deck areas for lounging and relaxation. Enjoy a dip in the upper deck Jacuzzi or chill out with a refreshing cocktail on one of the comfortable sunloungers.







ELEGANT INTERIORS

The yacht's interior has a contemporary feel, technologically advanced and timeless. Two stylish saloons offer ample space for indoor relaxation and entertainment. The main deck saloon's floor-to-ceiling panoramic windows provide an abundance of light and unobstructed views. The upper deck saloon is a less formal area and boasts a library of over 300 of the latest films.

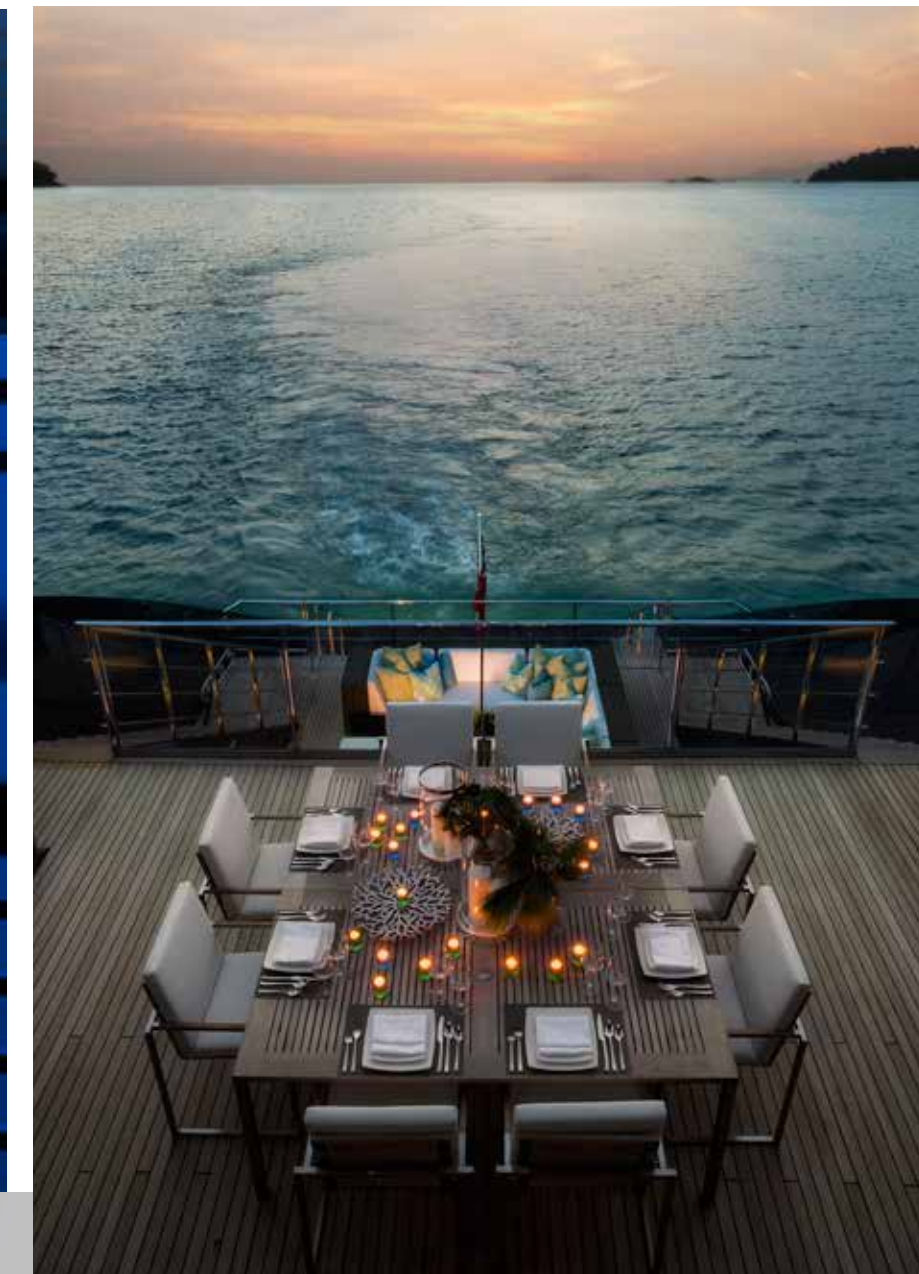

GOURMET DINING

Dine in supreme comfort with fabulous vistas.

Ocean Emerald boasts a variety of drinks and dining locations both indoor and al fresco. Hospitality is highly personalized onboard Ocean Emerald and everything is tailored to suit your needs. Our talented chefs can prepare a wide range of menu selections to fit all palates and dietary requirements.



LUXURIOUS LIVING

Enjoy spacious, comfortable living quarters with great views.

The master suite is the ultimate indulgence. A full beam residence with king-size bed, 60 inch TV, ocean-view sofas, ensuite bathroom and two private terraces.





MODERN FACILITIES

Ocean Emerald sleeps 12 guests in 5 state rooms with one master suite, 2 double bed VIP staterooms and two twin cabins with Pullman beds. All cabins have ensuite bathrooms. A state-of-the-art kitchen and fitness area complete the guest facilities. Additionally, the yacht accommodates 9 crew to ensure a relaxed, safe, luxury experience.



PLAY AND EXPLORE

With an armada of toys, tenders, jet skis, kayaks and sports equipment, Ocean Emerald is an ideal yacht for those looking for a fun fueled charter and the perfect vessel to explore the magical waters of South-East Asia.





MAGICAL JOURNEYS

The best of South-East Asia with Ocean Emerald.

With its home base in the Gulf of Thailand, Ocean Emerald is ideally placed to visit a wide range of beautiful locations in South-East Asia. Relax on the sundeck near Koh Samui making quick trips to the plethora of nearby idyllic islands. Alternatively venture north towards the spectacular Halong Bay or even journey to Hong Kong.

Indulge in a smooth cruise across South-East Asia, whether you'd like to visit the Andaman or the South China Sea, there's enormous potential for exploration. From the beaches of Koh Phuket, past the modern Singapore to the wildlife of the Gulf of Thailand, you're able to plan a route that fits you perfectly.

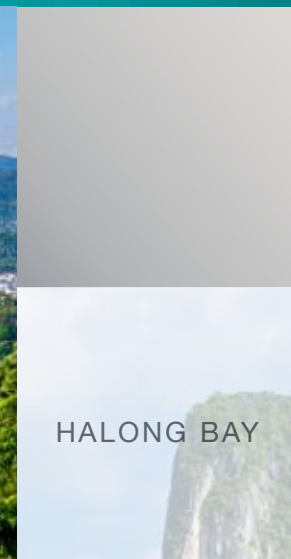

SOUTH-EAST ASIA

KOH SAMUI

HONG KONG

LANGKAWI

KOH PHUKET

HALONG BAY

SINGAPORE

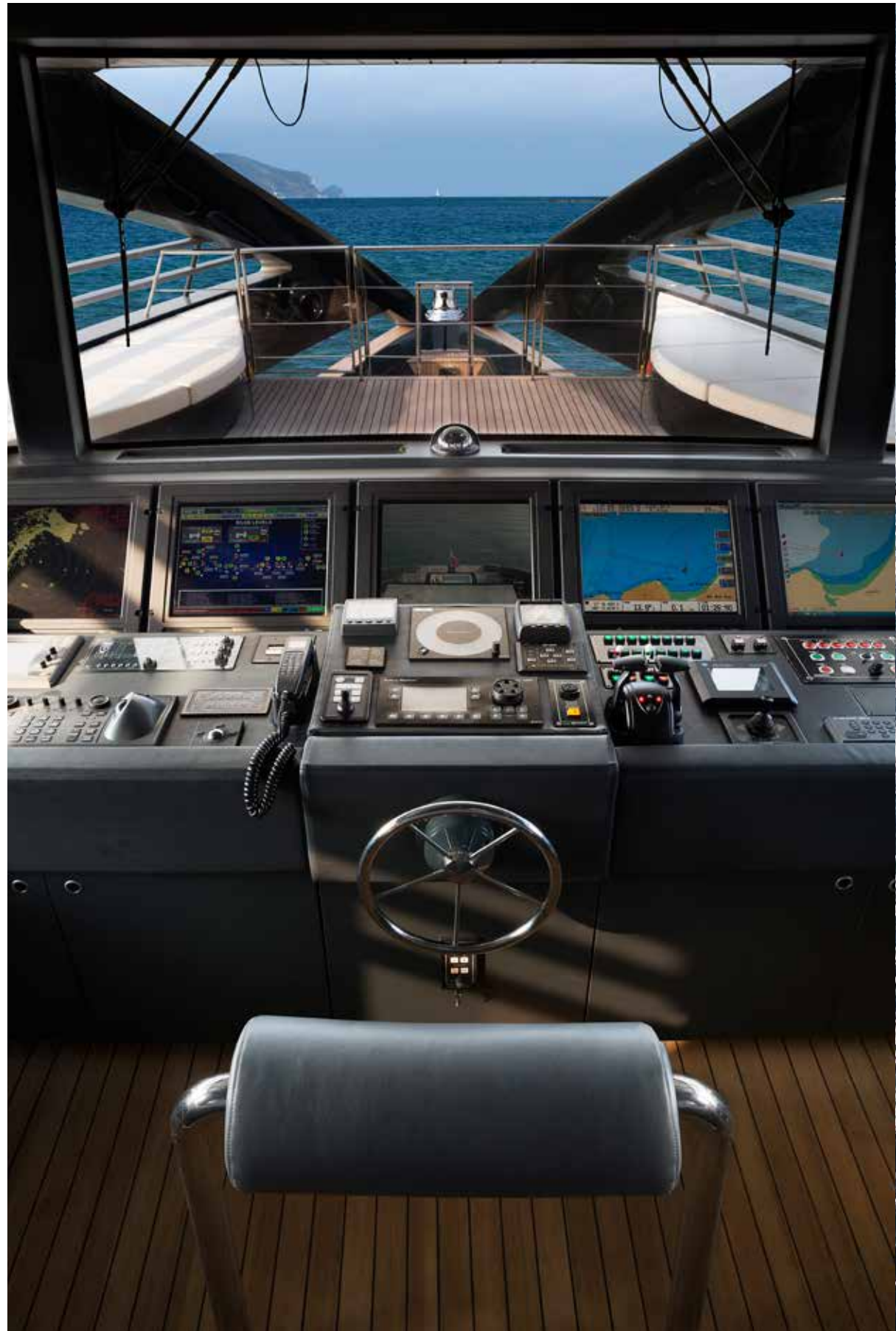

- DECK

- GUEST AREAS

- CREW/TECHNICAL AREAS

Sun Deck

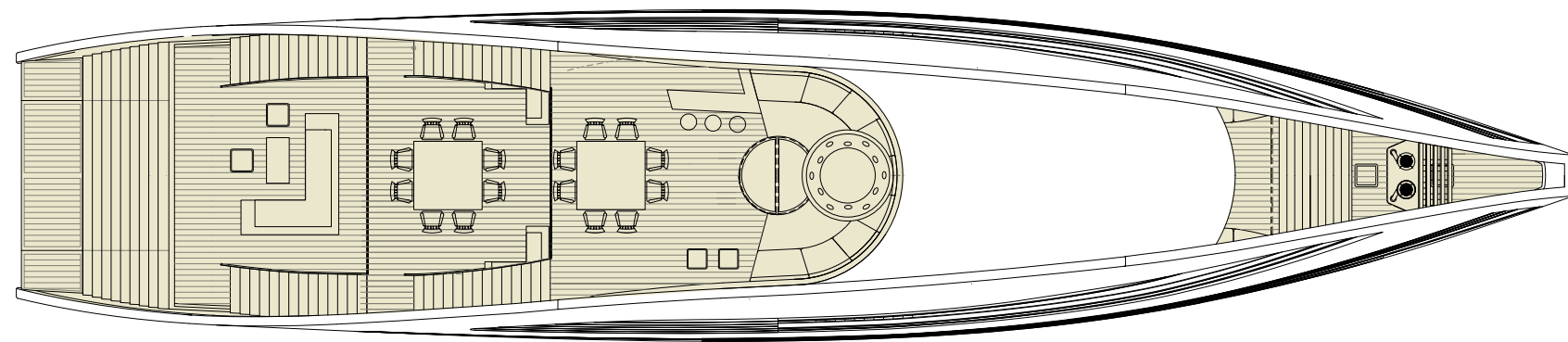

Main Deck

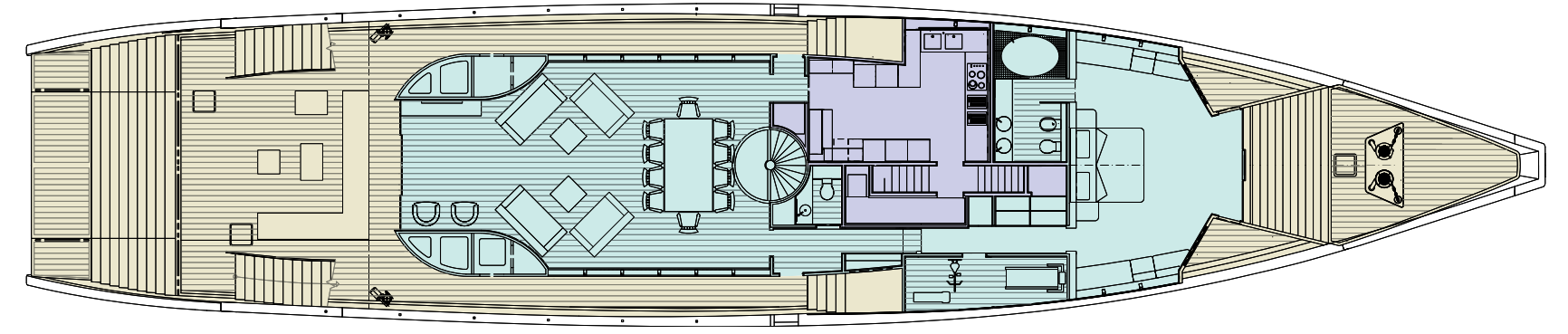

Upper Deck

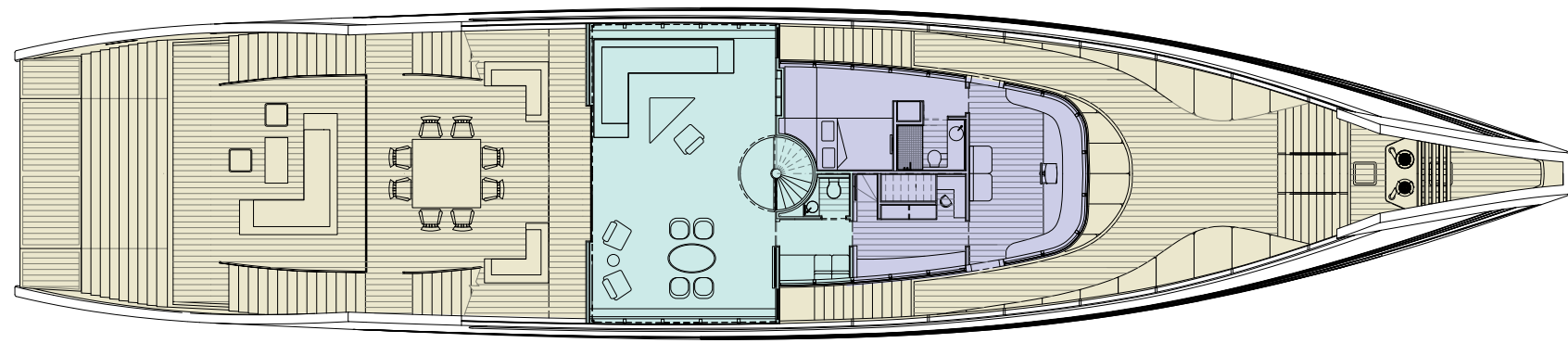

Lower Deck

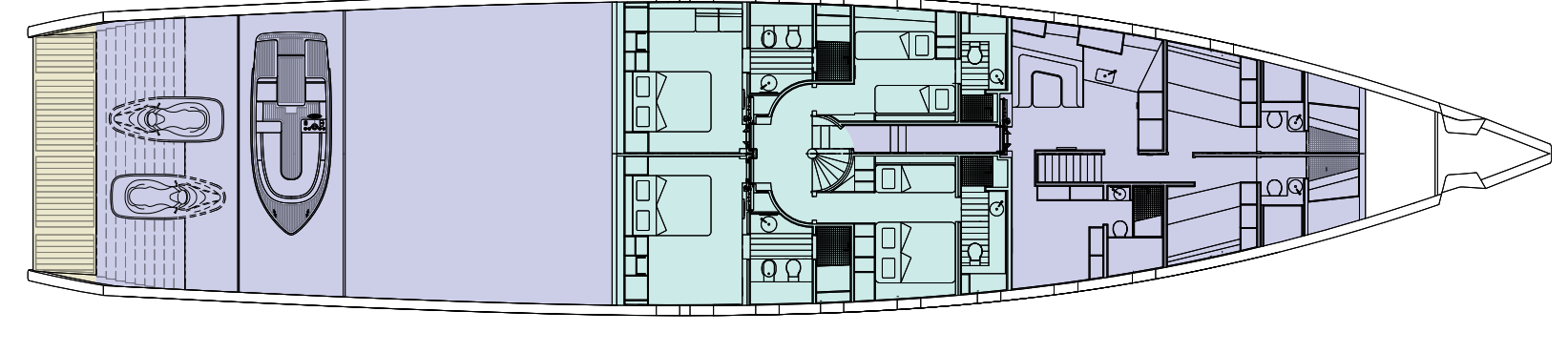

OCEAN EMERALD

Ocean Emerald is ideal for a safe, smooth cruising holiday. Based in Thailand, the yacht is uniquely placed to explore the islands and bays of South-East Asia.

She is built with an aluminium hull and super structure with floor to ceiling windows in the main salon. She features an ultra modern stabilisation system to reduce the roll motion affect whether at anchor or cruising.

Ocean Emeralds unique ultra modern design, gives an increase in space of over 30 percent compared to traditionally designed yachts of her size.

Technical Data

Length	41 meters
Beam	8.4 meters
Draft	2.4 meter
Range	2,600 miles
Fuel capacity	26,000 liters
Water capacity	8,000 liters
Power	2x caterpillar 1400HP
Generator	2x caterpillar 86KW
Gross tonnage	346 tonnes
Max speed	18 knots
Cruising speed	14 knots
Life Rafts	3x 8-man life rafts
Guests	12
Crew	9
Builder	Rodriguez Yachts
Designer	Foster and Partners
Year	2009/2015
Class	RINA and LY2 large commercial yacht code

Onboard Amenities

Swimming platform
Air conditioning
WiFi throughout the boat
Gym
Jacuzzi
Home cinema

Toys

2x Seadoo jet skis
1x Seadoo jet boat 5.5meters, four-seater
1x 15 meter BTS rib with Yamaha 90HP
2x one-seater kayaks
1x two-seater kayak
1x paddle board
Towable inflatables
Water skiing
Wake board
4x full sets of diving equipment
12x snorkeling equipment sets
Fishing equipment