



Mabrouk

130' 7" (39.8m) | Cantieri Di Pisa | 2004

Mabrouk

BASIC SPECIFICATIONS

BUILDER

Cantieri Di Pisa

BEAM (ft/m)

24' 8" (7.5m)

CRUISING/MAX SPEED

24 / 28 Knots

CREW

7

RANGE

LENGTH (ft/m)

130' 7" (39.8m)

DRAFT (ft/m)

7' 3" (2.2m)

FUEL CONSUMPTION

1150 Litres/Hr

ACCOMMODATION

12 guests in 5 cabins

INTERIOR DESIGNER

Studio Porfiri

BUILT/REFIT

2004 / 2012

GROSS TONNAGE

248 GT

ENGINES

2 x MTU 3630 hp

ARRANGEMENTS

3 Double, 2 Twin

Mabrouk

KEY FEATURES

- › HIGH CRUISING SPEED
- › CONVERTED TO ACCOMMODATE UP TO 12 GUESTS ONBOARD
- › 3 SIMILAR SIZE DOUBLE BED CABINS (2 ON LOWER DECK, 1 ON MAIN DECK)
- › EXPERIENCED CREW THAT HAS BEEN ON BOARD FOR MANY CONSECUTIVE YEARS
- › LARGE SUNDECK
- › LOW DRAFT

Mabrouk

WATER TOYS

- › 1 X 5.50M TENDER "NOVURANIA DELUXE" MODEL 2020 WITH OUTBOARD ENGINE YAMAHA 130HP (THE TENDER IS EQUIPPED WITH PLOTTER, ECHO SOUNDER, SOUND SYSTEM GPS, VHF, UNDERWATER LIGHTS)
- › 1 X 3.40M TENDER "ZODIAC" MODEL 2018 WITH OUTBOARD ENGINE YAMAHA 6HP
- › 1 X JET SKI YAMAHA FZR SVHO 1800 COMPRESSOR 260 HP THREE-SEATER
- › 1 X STAND UP PADDLE BOARD
- › 1 X CANOE KAYAK TWO-SEATER
- › 2 X WAKE BOARDS
- › 1 X KNEE BOARD
- › 2 X TUBES DONUT TYPE FOR 1 X PERSON EACH
- › 2 X SETS WATER SKI (CHILDREN)
- › 2 X WATER SKI SETS (ADULTS)
- › 1 X INFLATABLE SOFA 3 PRS
- › SNORKELING EQUIPMENT
- › LIFE VESTS FOR WATER TOYS

MABROUK



MABROUK























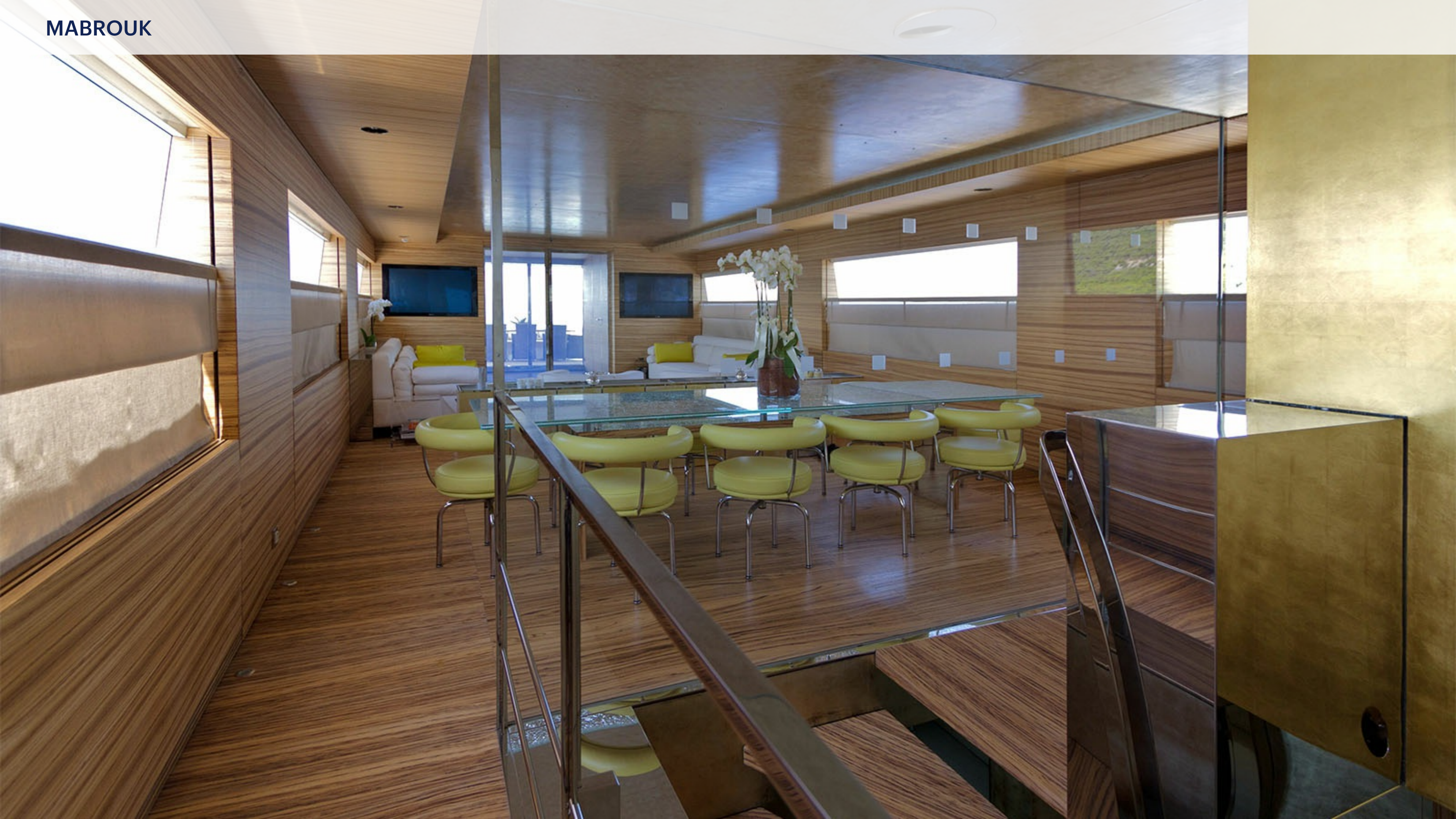

























MABROUK







MABROUK



MABROUK

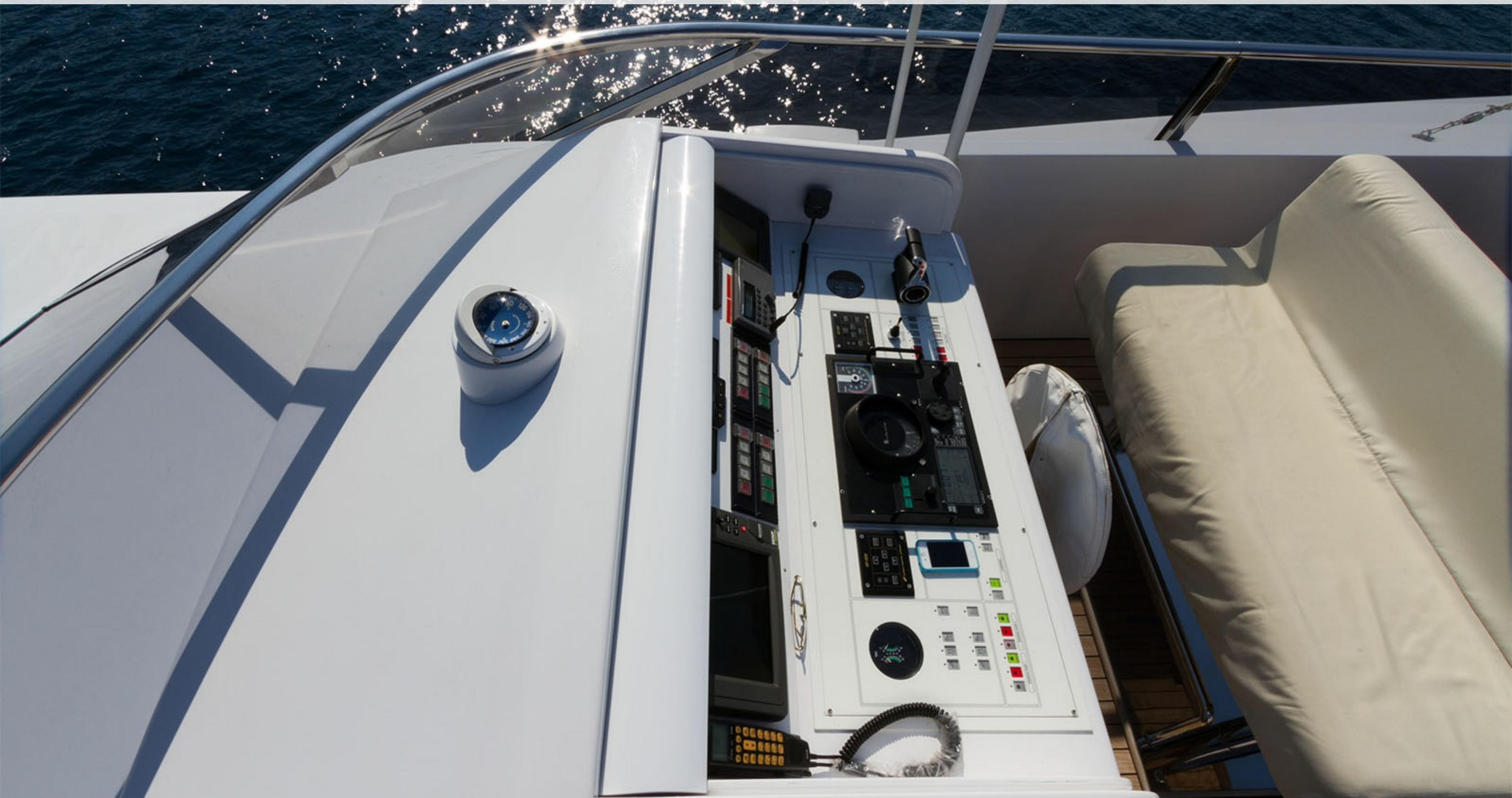

MABROUK



MABROUK



MABROUK



MABROUK





MABROUK







MABROUK



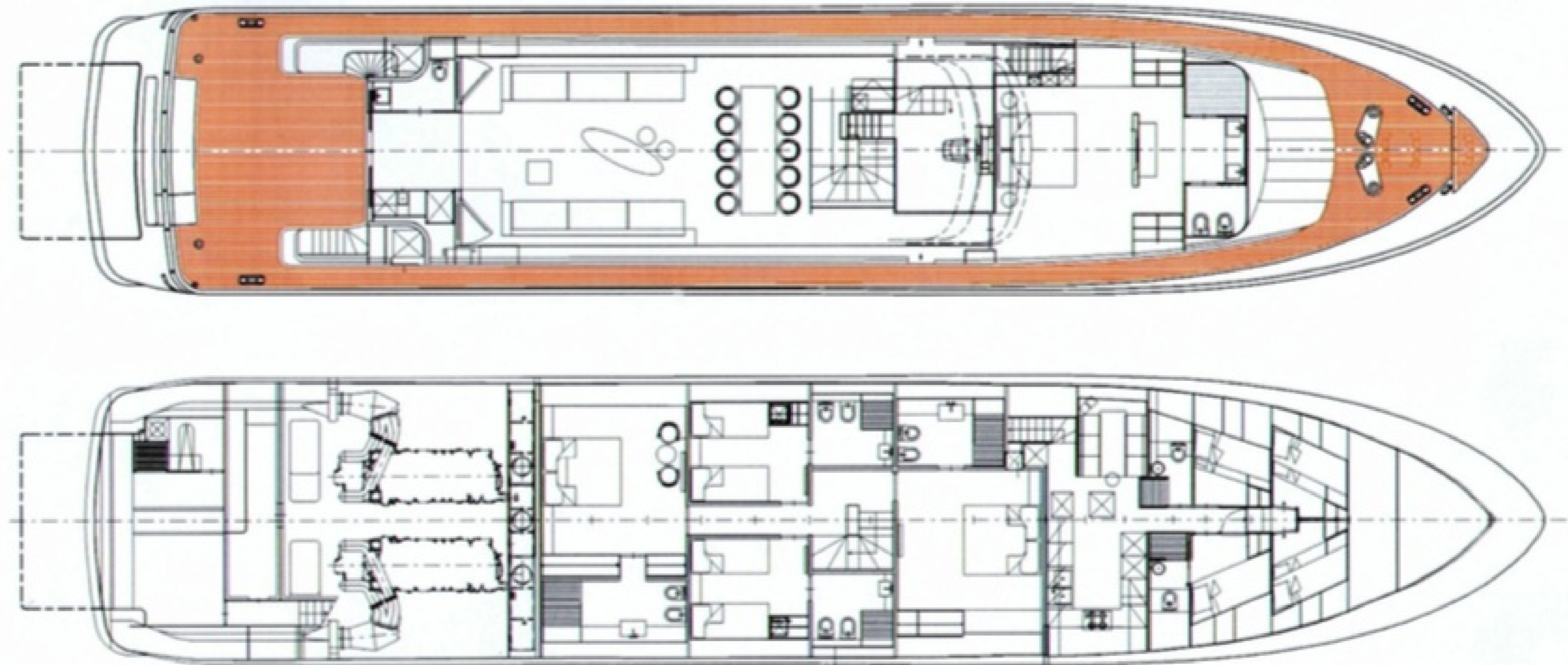

AKHIR 125
Piani Generali C