

# LA MIRAGE



## SPACE & STYLE

This 52m yacht boasts comfort and quality at a level one would expect from the prestigious Amels shipyard. Built to the exacting standards set by her experienced Owner, La Mirage is a perfect example of five star luxury afloat. Her open, contemporary interior is a breath of fresh air and has the atmosphere of a luxurious beach house. All you have to think about is which view you would like - bustling Italian port, secret, silent anchorage or palm fringed tropical island.



# THE ART OF RELAXATION

The sky lounge on the bridge deck blurs the boundaries between inside and out with sliding doors leading to the aft deck with dining table and seating.



Luncheon on the bridge deck aft.

PRIVACY IS A LUXURY



# HOT & COOL

Sunlight rippling on the water works its hypnotic magic on the sun deck. The jacuzzi dip pool, the gentle breeze and a cocktail from the bar conspire to make you relax.



## CORAL & CREAM

The main saloon and dining area on the main deck.  
Louvered shutters keep out the glare of the sun in this  
deliciously cool interior with hot coral accents.



# RETREAT & REST

The full width master suite is a sanctuary of calm. There is a lounge area, study area and dressing room. The mirrored, marble bathroom has a jacuzzi bath and shower room.



# FRIENDS & FAMILY

Guests are accommodated in two doubles and three twins, all en suite. The light dances on the blond wood panelling as the yacht glides on to the next location.





# POWER UP

Explore above the waterline on one of the waverunners - below the waterline with the SeaBob or the snorkelling gear. There are waterskis, wakeboards and inflatable toys too.



# SPECIFICATION

**TYPE**  
Twin Screw Diesel Displacement Yacht

**FLAG**  
Cayman Islands

**DIMENSIONS**  
Length O.A. 52m (170.6ft)  
Beam 9m (29.5ft)  
Draft 3.2m (10.5ft)

**TONNAGE**  
Gross 649  
Net 198

**YEAR BUILT**  
2007

**BUILDER**  
Amels Holland BV, The Netherlands

**EXTERIOR & INTERIOR DESIGN**  
Exterior: Tim Heywood  
Interior: Laura Sessa

**CONSTRUCTION**  
Steel hull, aluminium superstructure, teak decks

**CLASSIFICATION**  
Lloyds + 100 A1 SSC Yacht Mono G6

**MACHINERY**

**MAIN ENGINES**  
2 x 1408hp MTU 16V 2000 M70 diesels,  
1050 kW @ 2100 rpm each

**SPEEDS**  
Cruising speeds of 13 knots (300 litres per hour)  
Maximum speed of 15 knots (480 litres per hour)

**RANGE**  
Range @ 13 knots: 4,500 nautical miles

**GENERATORS**  
2 x generator sets 190-kVA each  
3-phase 230/400 VAC  
50 Hz 1 x emergency generator set 62.5 kVA

**ROLL CONTROL**  
Naiad 820L stabilizers

**AIR CONDITIONING**  
Heinen & Hopman

**COMMUNICATION EQUIPMENT**  
Satcom & cellular communications facilities  
VSAT  
Fleet 77  
Wi-Fi internet access

**ENTERTAINMENT**  
Comprehensive audio-visual systems  
Satellite television  
iPod docks  
Wii games console

**ACCOMMODATION**  
12 guests in 3 doubles and 3 twins  
Main deck  
Master suite with adjoining office, walk-in wardrobe  
and bath and shower room en suite  
Twin cabin with shower room en suite  
Lower deck  
2 x double cabins, each with bathroom en suite  
2 x twin cabins each with shower room en suite and pullman  
13 crew in 8 cabins

**TENDERS & TOYS**  
5.8m Nautica RIB 19 Wide body with 190hp inboard engine  
5.5m Nautica RIB 18 Wide body with 150hp outboard engine  
3 x Sea-Doo GTX (3 man)  
2 x Sea-Doo GTX (2 man)  
1 x SeaBob Cayago VX2A  
Waterskis, wakeboards & tows

**JACUZZI DIP POOL**

**GYM EQUIPMENT**  
AMT 100i cross trainer  
Techno Gym treadmill  
Free weights and bench

All particulars are believed to be correct but cannot be guaranteed.

# DECK PLANS



SUN DECK

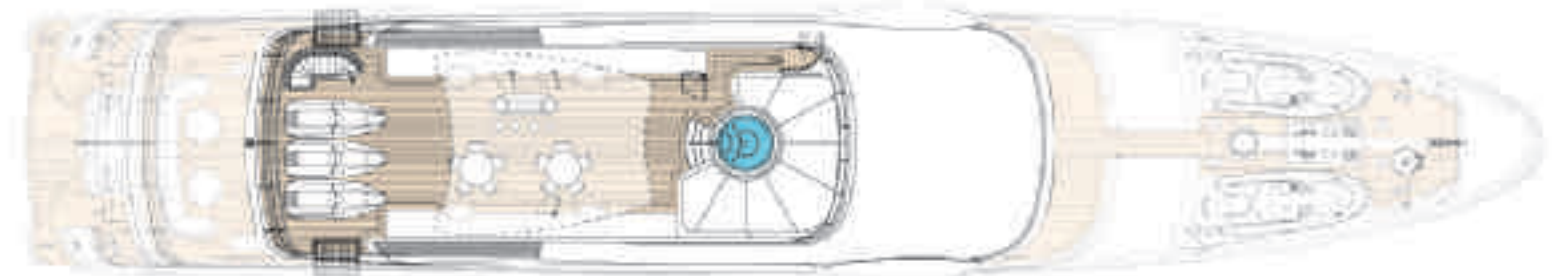

BRIDGE DECK

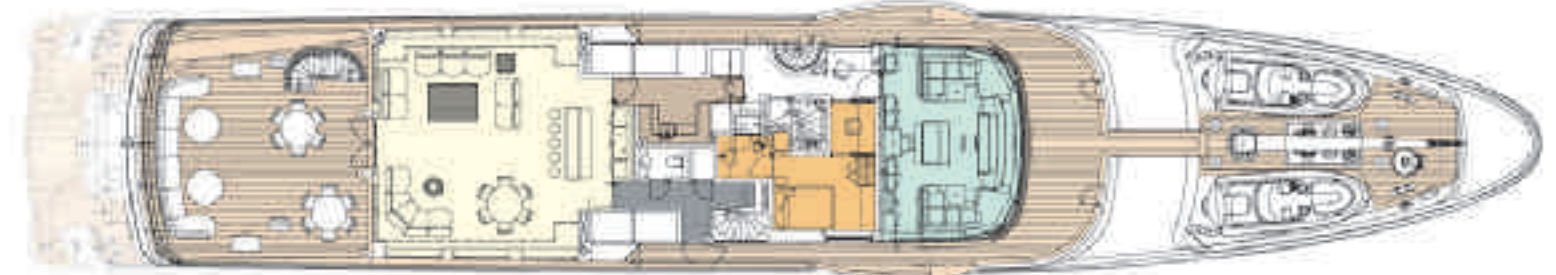

MAIN DECK

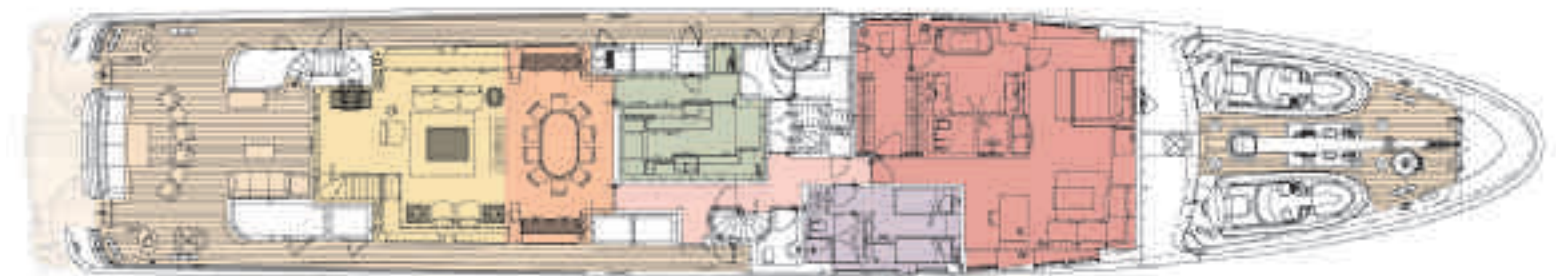

LOWER DECK

