

FOR CHARTER

# JEMS



A yacht for the modern charterer, 44m Jems brings together functional and artistic design, modern amenities, an arsenal of water toys and the wisdom and knowledge of an experienced charter crew.

# A YACHT FOR THE MODERN WORLD

Once aboard, Jems continues to shine with multiple, adaptable deck spaces that seamlessly take her guests from day to night. Whether it's a private breakfast on the foredeck, an afternoon soak in the sun deck jacuzzi with swim up bar, dinner on the upper deck aft or a midnight movie under the stars, Jems has you covered round the clock.

FOR CHARTER

JEMS



# SPECIFICATION



**BUILDER**  
HEESEN

**GUESTS**  
10 IN 5 CABINS

**LENGTH**  
44M (144'4")

**DRAFT**  
2.5M (8'2")

**BUILT**  
2009

**CREW**  
8

**BEAM**  
9M (29'6")

**MAX SPEED**  
25 KNOTS

Streamlined and distinct exterior lines penned by Omega Naval Architects and Northern European build quality from Heesen have resulted in a high performing, fast motor yacht. At a top speed of 25 knots, Jems allows you to take in more of your chosen destination and is one of the few charter yachts of this length to reach such exhilarating speeds.





Jems has a bespoke and contemporary interior by Eric Benqué. Calm, uncluttered spaces with clever details such as versatile modular tables, have been arranged to enhance the feeling of ease on board.

# BESPOKE DESIGN

The aesthetic is complemented by a vibrant art collection including pieces by Pablo Picasso, Calder and Michael Craig-Martin.







MAIN DECK



JEMS





MAIN DECK



JEMS







BRIDGE DECK



JEMS

Jems can accommodate up to 10 guests in 5 spacious suites, two of which can be set up as either a twin or double room, perfect for family groups travelling together.

# FLEXIBLE FOR EVERYONE

Contemporary style and clever storage solutions enhance the feeling of space in each guest cabin.





PRINCIPAL CABIN



JEMS



GUEST CABINS

JEMS



GUEST CABINS

JEMS



Comfortable deck spaces seamlessly take guests from day to night with multiple, adaptable entertainment spaces, including a sun deck with jacuzzi, swim up bar and outdoor cinema screen, a forward area with cosy casual dining tables and large sun pad and a spacious upper deck aft al fresco dining space.

# FROM DAY TO NIGHT

There is a space for every occasion or any mood. With the choices available, guests will find it hard to leave.





SUN DECK

JEMS



SUN DECK

JEMS



BRIDGE DECK FORWARD

JEMS





BRIDGE DECK AFT



JEMS



BRIDGE DECK AFT

JEMS





EXTERIOR LIVING



JEMS

**TREADMILL X1**  
**EXERCISE BIKE X1**  
**TRX X1**  
**ADJUSTABLE WEIGHT BENCH**  
**(X2 DUMBBELLS / X1 KETTLEBELL)**  
**GYM BALL X1**  
**WEIGHTS**  
**ELASTIC BANDS**  
**MATS**

# ONBOARD GYM

In keeping with her thoroughly modern offering, Jems carries an arsenal of state-of-the-art toys to suit all ages and all moods from inflatables and kayaks to stand up jet skis and Seabobs. Her expert crew are on hand to make sure you have unlimited fun in safety. All you have to worry about is which one to try first.

# TOYS TO SUIT ALL MOODS

# YAZZA

Yazza is an amphibious 9.4m Iguana chase tender. Guests are transported in style and comfort thanks to the versatile craft's capabilities. Yazza is perfect for exploring secluded beaches and hidden coves.







# THE TOYBOX

IGUANA X100 CHASE TENDER "YAZZA" 9.44M  
YACHTWERFT MEYER CUSTOM JET TENDER 6.5M  
YAMAHA VX CRUISER JET SKI X1  
YAMAHA VX 1 JET SKI X1  
YAMAHA STAND UP JET SKI X1  
E-FOIL FLITE X1  
SEABOBS X2  
WINDSURF X1  
PEDALBOARD HOBIECAT X1  
JOBE WAKE BOARD X1  
SLALOM MONO SKI ADULT X1  
BEGINNER BI-SKIS X1  
INFLATABLE STAND UP PADDLE BOARDS X2  
SURFBOARD X1  
INFLATABLE KAYAK X1 PPL  
INFLATABLE KAYAK X2 PPL  
JOBE TRIBAL TOWABLE X3 PPL  
JOBE CRUSHER TUBES (DOUGHNUTS) X2  
SNORKELLING EQUIPMENT X12 PPL  
GOLF PRACTICE MAT X1  
BEACH VOLLEYBALL NET KIT X1  
BEACH CAMP SETTING  
(TENT/TABLES/CHAIRS) X1  
FOLDABLE BICYCLE X2  
ELECTRIC SCOOTER X1



TENDERS & TOYS



JEMS



FOR CHARTER

JEMS



## SUN DECK & BRIDGE DECK

## MAIN DECK & LOWER DECK

### KEY

- DECK
- GUEST AREAS
- PRINCIPAL CABIN
- GUEST CABINS
- SUN DECK
- CREW AREAS

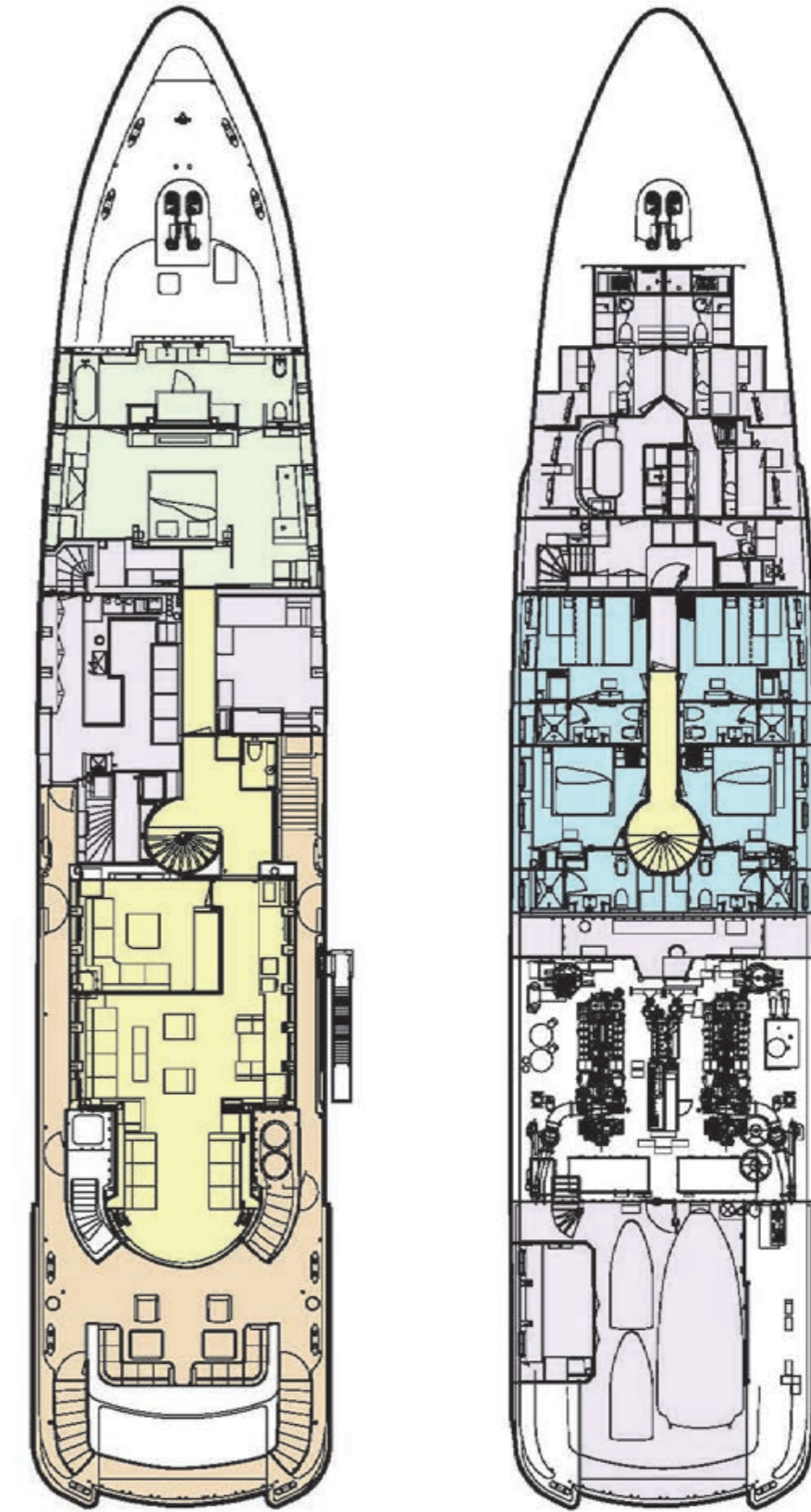
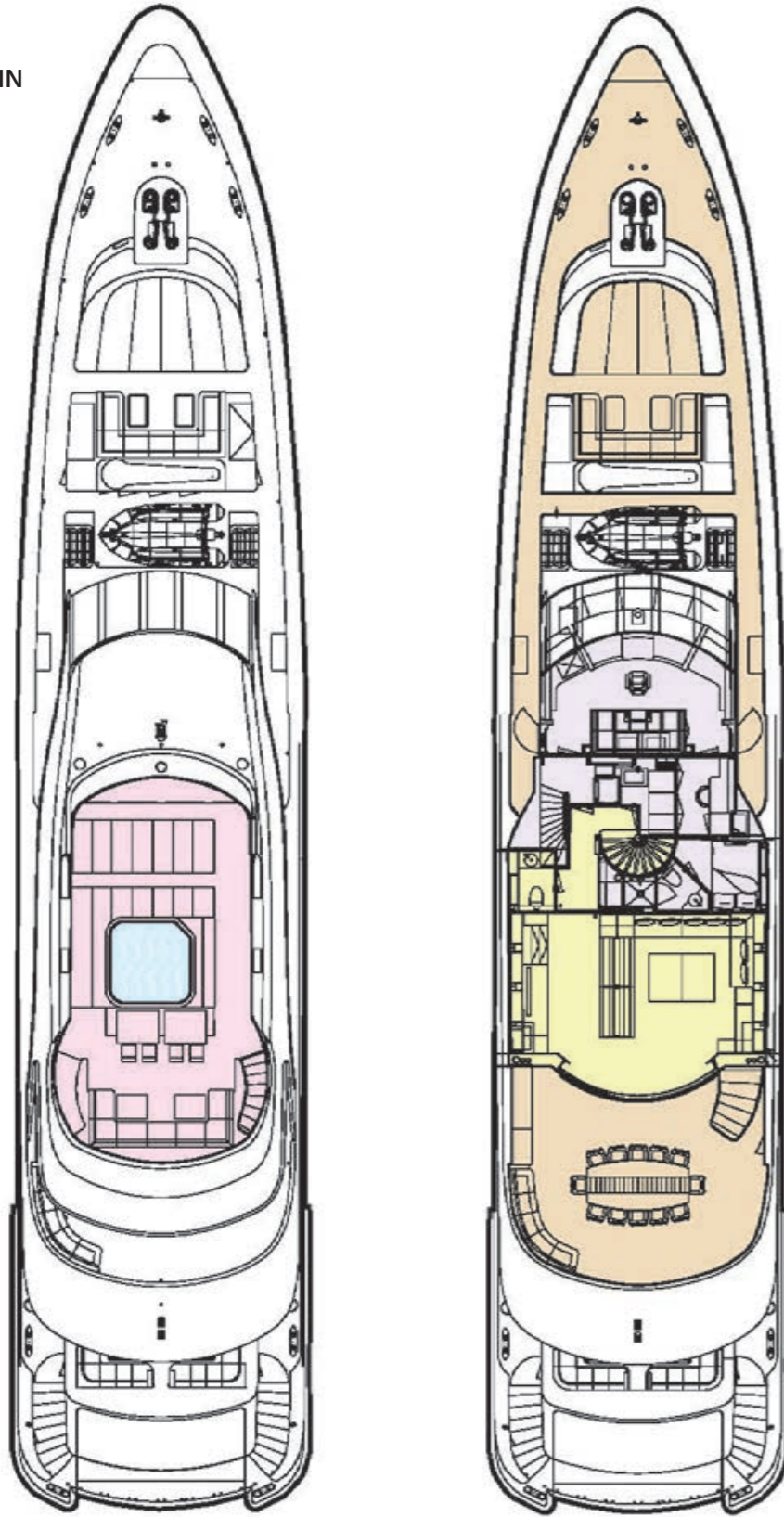

# SUN DECK

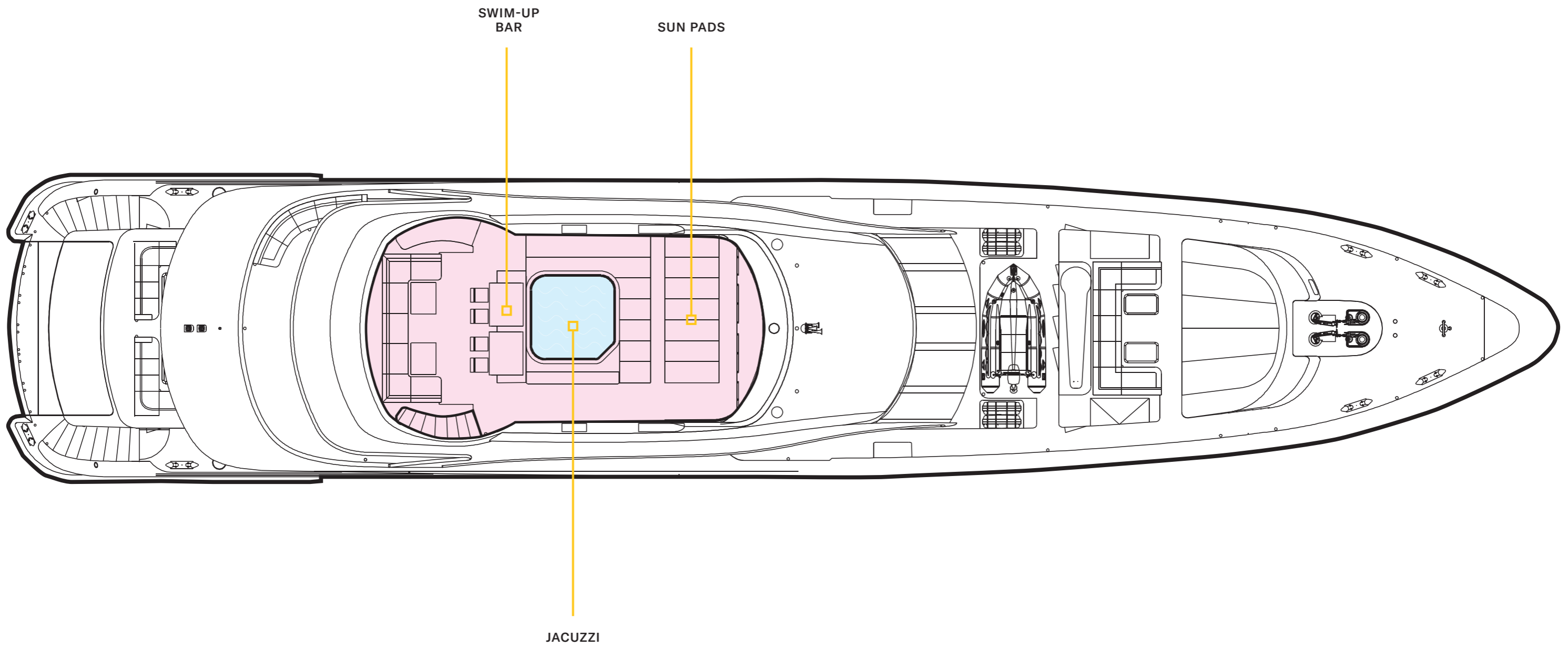

## KEY

- DECK
- GUEST AREAS
- PRINCIPAL CABIN
- GUEST CABINS
- SUN DECK
- CREW AREAS

# BRIDGE DECK

AL-FRESCO  
DINING

DAY  
HEAD

SEATING AREA  
& SUN PADS

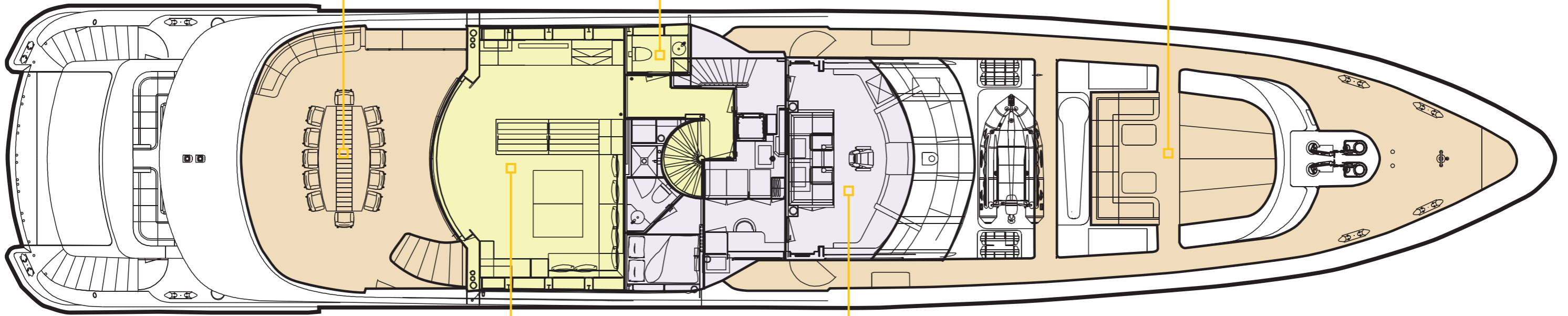

UPPER SALON  
& DINING AREA

BRIDGE

## KEY

- DECK
- GUEST AREAS
- PRINCIPAL CABIN
- GUEST CABINS
- SUN DECK
- CREW AREAS

# MAIN DECK

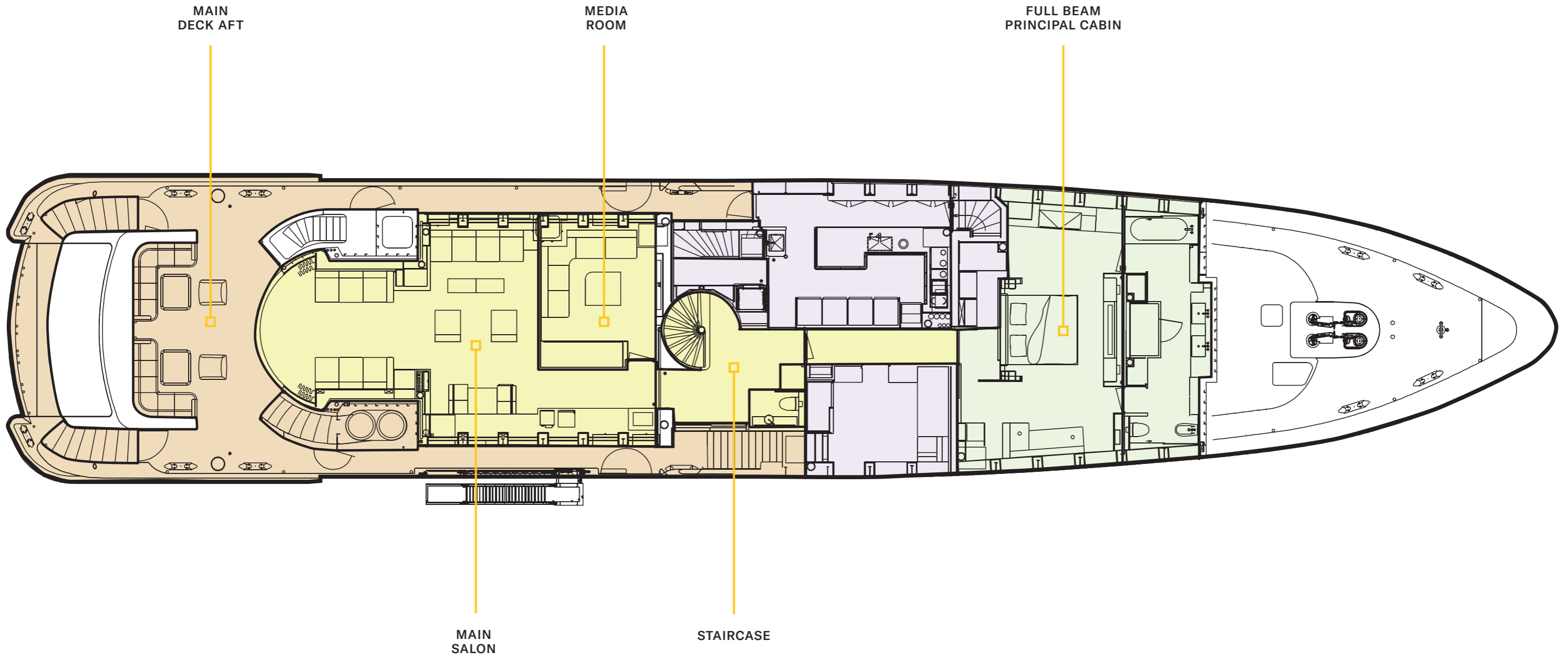

## KEY

- DECK
- GUEST AREAS
- PRINCIPAL CABIN
- GUEST CABINS
- SUN DECK
- CREW AREAS

# LOWER DECK

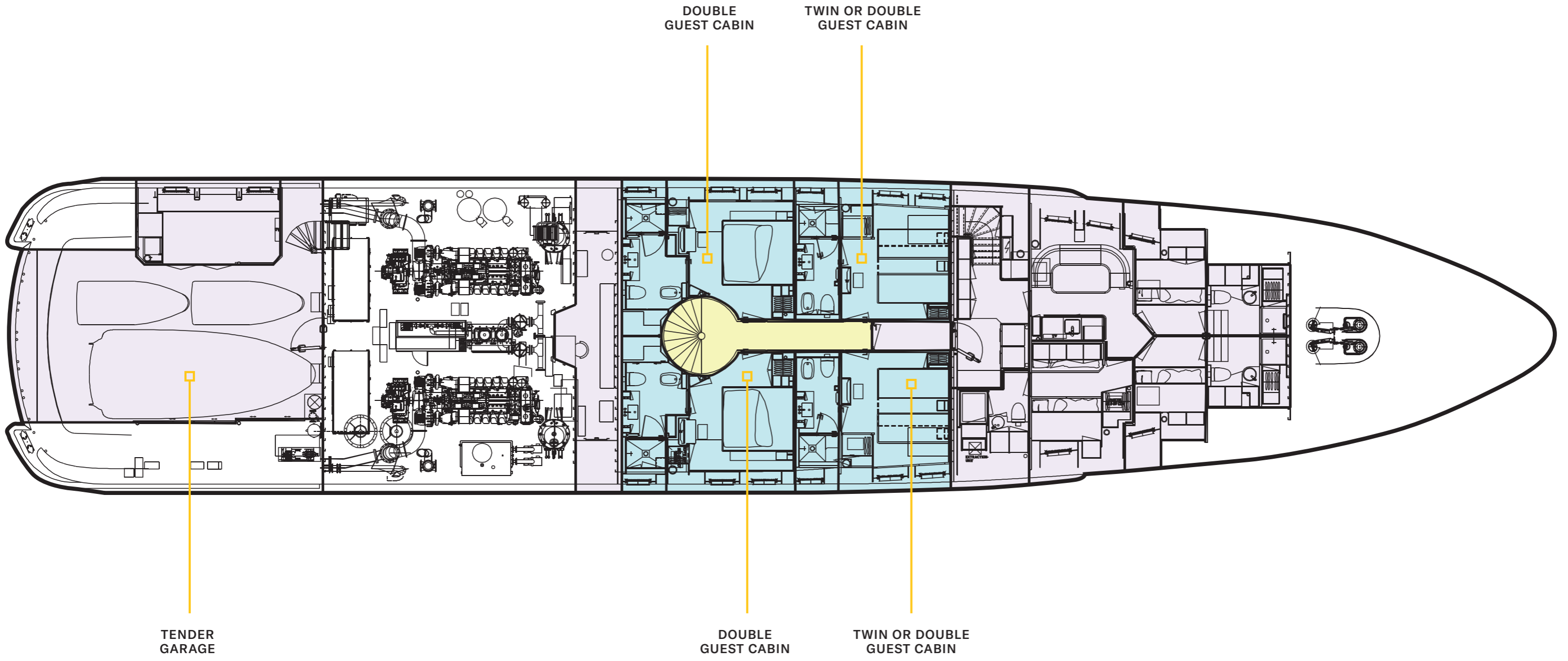

## KEY

- DECK
- GUEST AREAS
- PRINCIPAL CABIN
- GUEST CABINS
- SUN DECK
- CREW AREAS

FOR CHARTER

# JEMS

