

DXB

35.00M (114'10") | BENETTI | 2003/2022



AN IDEAL ADVENTURE CHARTER

Built in 2003 and refitted in 2022, DXB is the ideal luxury yacht for kicking back and relaxing whilst on charter, showcasing clever use of space with an artful combination of integrated systems and luxurious features, she's a crowd-pleaser for sure. If it's excitement on the water that you're seeking, then DXB comes with a range of accessories and water toys to keep charter guests entertained all day long. DXB also sports a Tender to transport you with ease. DXB is a unique motor yacht and the ideal platform for an adventure charter that will guarantee unforgettable memories.







Built with a GRP hull and superstructure, she benefits from a semi-displacement hull to provide exceptional seakeeping and impressive speeds. Powered by twin Caterpillar engines, she comfortably cruises at 12 knots in fuel economy and reaches a maximum speed of 15 knots with a cruising range of up to 3,200 nautical miles. An onboard stabilization system ensures comfort when underway.





DXB

DXB



WELCOME ONBOARD

Tri-deck DXB designed by Stefano Righini has great exterior living. The main deck aft features a large alfresco dining table and direct access to the salon, ideal for formal or casual entertaining. On the upper deck, adjacent to the skylounge, is a further alfresco dining table under overhead shade, followed by plush exterior furnishings.



MAIN DECK AFT SEATING AREA



UPPER DECK AFT SEATING AREA



UPPER DECK AFT SEATING AREA



UPPER DECK AFT AL-FRESCO DINING AREA



UPPER DECK AFT AL-FRESCO DINING AREA



UPPER DECK AFT AL-FRESCO DINING AREA



UPPER DECK AFT



UPPER DECK AFT



STAIRCASE

The sundeck rearranged to allow a large seating area and featuring a recently installed teak deck, is partially shaded and features various amenities including a wet bar, alfresco dining, chaise loungers, ample seating and a deluxe Jacuzzi tub, perfect to enjoy the scenery with your favourite drink in hand. On the stern of the yacht are dual steps to the swim platform and a large water toys garage with a great selection of water toys to choose from.





SUN DECK BAR



SUN DECK BAR



SUN DECK JACUZZI



SUN DECK LOUNGING AREA



SWIM PLATFORM

INTERIOR LIVING

This yacht features fantastic interior styling by French designer Zuretti. Her Hermes interior is contemporary and elegant, featuring high gloss cherry-toned woods, sumptuous soft furnishings and a light airy ambiance throughout. The salon lounge on the main deck offers plenty of relaxing seating and is surrounded by panoramic windows. Further forward on the starboard side, the guest foyer leads to the stylish formal dining area. An upper sky lounge is decorated by Ralph Lauren and offers further seating, a desk and an inviting pantry and a well-equipped bar.



MAIN SALON



MAIN SALON



MAIN SALON



MAIN SALON



DINING AREA



DINING AREA



DINING AREA



DINING AREA



DINING AREA



MAIN DECK BAR



STAIRCASE



UPPER DECK SALON



UPPER DECK SALON



UPPER DECK BAR



STAIRCASE

ACCOMMODATION

DXB offers guest accommodation for up to 10 guests in 5 well-appointed staterooms comprising a master suite, two double cabins and two twin cabins. The master cabin allocated in the main deck is full beam with a king-size bed, sofa and full beam en-suite with tub and shower. Two guest cabins have queen-size beds and a further 2 cabins have side-by-side twin beds. There are 7 beds in total, including 1 king, 2 queen, 2 doubles and 4 singles. All cabins are en-suite. DXB is also capable of carrying up to 7 crew in 4 cabins onboard to ensure a relaxed luxury yacht charter experience.



MASTER STATEROOM



MASTER STATEROOM



MASTER STATEROOM



MASTER STATEROOM



MASTER STATEROOM



MASTER BATHROOM



MASTER BATHROOM



MASTER BATHROOM



DOUBLE STATEROOM



GUEST BATHROOM



DOUBLE STATEROOM



GUEST BATHROOM



TWIN STATEROOM



TWIN STATEROOM



GUEST BATHROOM



GUEST BATHROOM

SPECIFICATIONS

CATEGORY: **MOTOR YACHT**
LOA: **35.00M / 114'10"**
BEAM: **6.90M / 22'8"**
DRAFT: **2.00M / 6'7"**
BUILDER: **BENETTI**
MODEL: **CLASSIC 115'**
BUILD YEAR: **2003**
REFIT: **2022**
EXTERIOR DESIGNER: **STEFANO RIGHINI**
NAVAL ARCHITECT: **BENETTI**
INTERIOR DESIGNER: **ZURETTI**
HULL & SUPERSTRUCTURE: **GRP**
DECK MATERIAL: **4**
DECKS: **TEAK**
DISPLACEMENT: **SEMI-DISPLACEMENT**
GRT: **254**
FLAG: **UNITED ARAB EMIRATES**
CLASS: **RINA**

SUMMER BASE PORT: **NAPLES, ITALY**
WINTER BASE PORT: **DUBAI, UNITED ARAB EMIRATES**
SUMMER CRUISE REGION: **WEST MEDITERRANEAN**
WINTER CRUISE REGION: **PERSIAN GULF / ARABIAN SEA**

GUESTS SLEEPING: **10**
GUESTS CRUISING: **50**
NUMBER OF CABINS: **5**
CABIN CONFIGURATION: **1 MASTER, 2 DOUBLE, 2 TWIN**
BED CONFIGURATION: **1 KING, 2 QUEEN, 2 DOUBLE, 4 SINGLE**
CREW: **7**

ENGINES: **2 X CATERPILLAR DIESEL 3412E, 1,400HP**
FUEL CAPACITY: **175L**
CRUISING SPEED: **12 KNOTS**
MAXIMUM SPEED: **16 KNOTS**
CRUISING RANGE: **3,200 NM**



FEATURED HIGHLIGHTS

- METICULOUS CONDITION, FOLLOWING A MAJOR 2022 REFIT
- A WHOLE HOST OF LUXURIOUS AMENITIES AND ELEGANT SPACES ACROSS HER 4 DECKS
- NEW LOOK CLASSIC INTERIOR BY HERMES WITH STYLISH DÉCOR INCLUDING SKY LOUNGE BY RALPH LAUREN
- TWO INTERIOR LARGE SALOONS, MAIN DECK OPEN LAYOUT AND THE UPPER SALON CONVERTED TO A CINEMA/TV ROOM
- INVITING JACUZZI, WET BAR AND NEW TEAK DECK
- MULTIPLE ALFRESCO DINING AREAS ON THE MAIN AFT DECK AND THE UPPER DECK
- HOSTS UP TO 50 GUESTS AT EVENT CHARTERS
- HUGE FULL BEAM MASTER CABIN OFFERING VIEWS THAT STRETCH FAR ACROSS THE OCEAN
- LARGE VARIETY OF WATER EQUIPMENT INVENTORY INCLUDING A JET SKI AND A NEW TENDER – PERFECT FOR EXPLORING WARM WATERS AND EXCITING DESTINATIONS
- A CREW OF 7 ALWAYS ON HAND TO CREATE A HIGH-END LUXURY CHARTER EXPERIENCE

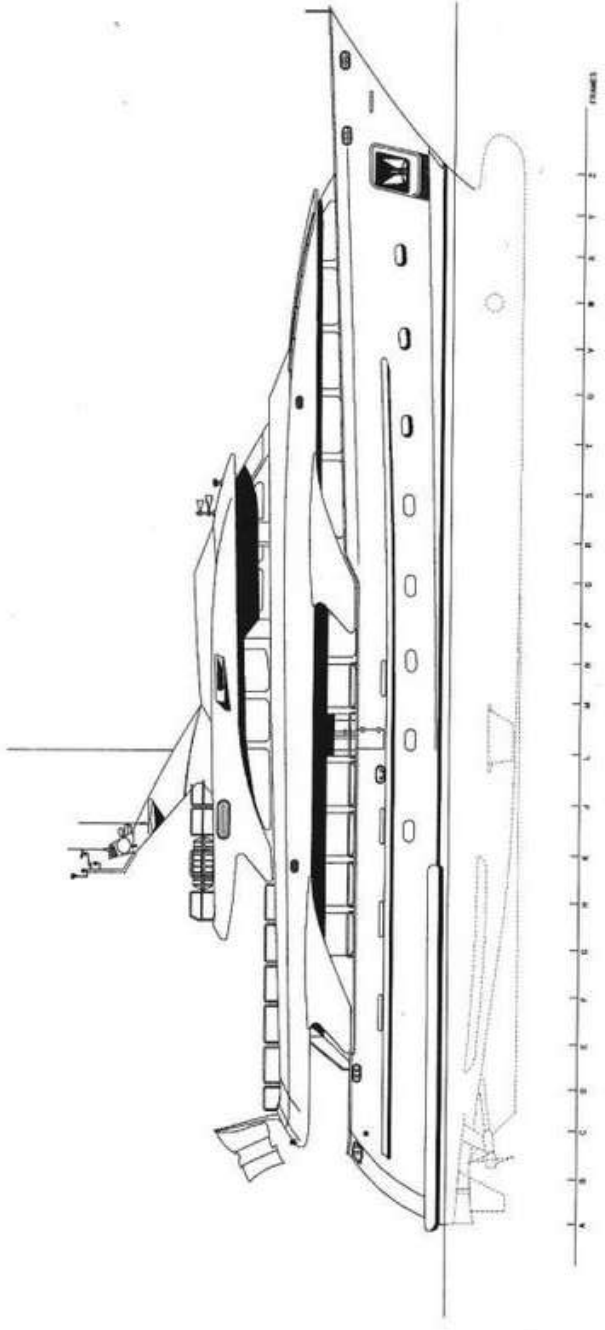

BC007

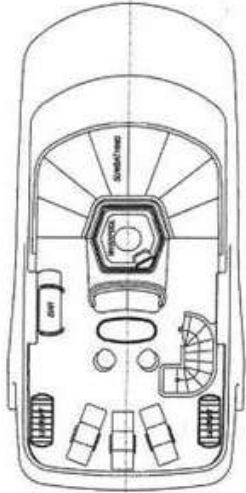

SUN DECK

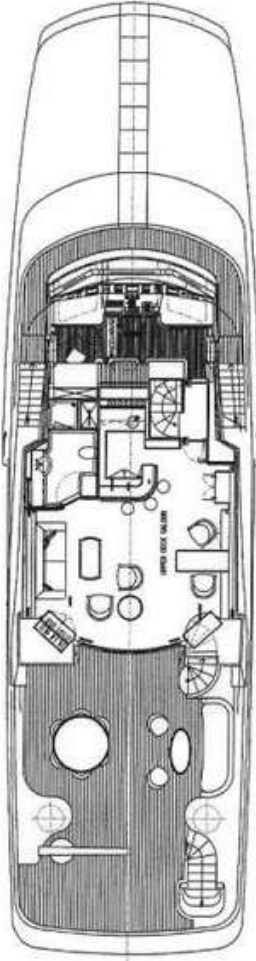

UPPER DECK

BC007

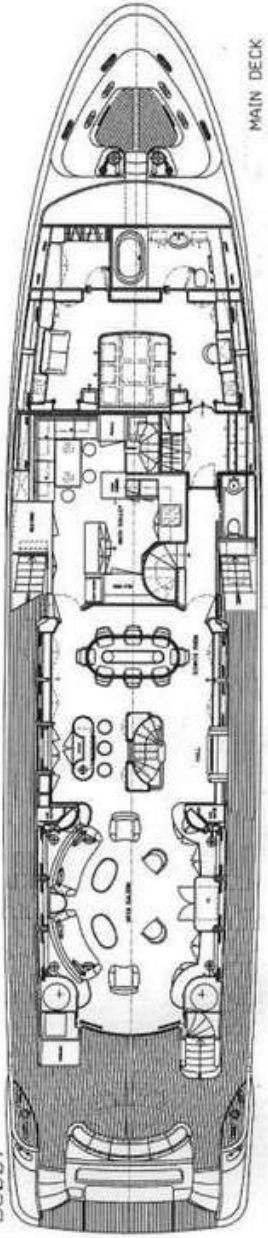

MAIN DECK

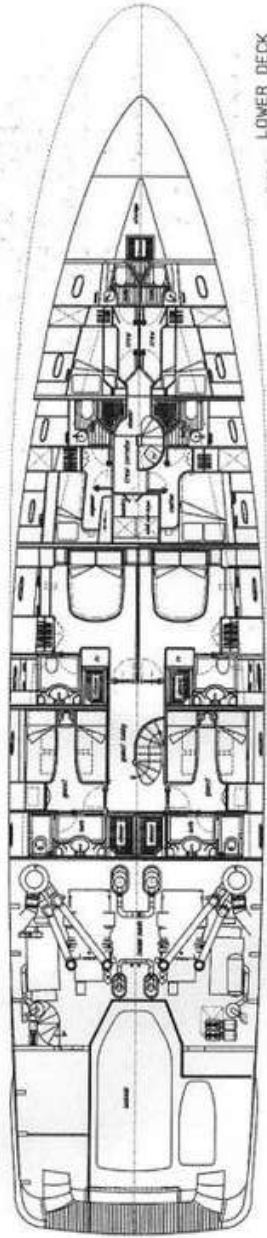

LOWER DECK

GENERAL ARRANGEMENT

