

CHARTER BROCHURE

LADY FIRST



Specifications

Builder	Built/Refit
Riva	2023
Length	
131' (40m)	
Beam	Draft
25' 9" (7.86m)	7' 6" (2.29m)
Guests	Crew
11 in 5 cabins	7
Cruising Speed	Max Speed
17kn	22kn
Tenders	
5.2m (17ft) 2022 Williams SportJet 520w 230hp engine	





LADY FIRST

The Essence of Elegance

A masterpiece of modern yacht design, LADY FIRST sets the standard for elegance and adventure. This stunning Riva 131 Bellissima offers an unparalleled charter experience, where sleek lines and expansive decks create a seamless indoor-outdoor flow. Her lavish 60-square-meter beach club serves as the ultimate waterfront retreat, while the sundeck and upper deck dining area provide exquisite alfresco entertainment. For the primary guests, a private bow terrace is complete with a jacuzzi, lounge, and sun pad that extends from the upper deck, ensuring exclusive relaxation. With state-of-the-art amenities, underwater lights, and high-speed water toys, LADY FIRST delivers both thrilling adventures and tranquil escapes. Whether unwinding in the bow jacuzzi, dining under the stars, or diving into crystal-clear waters, every moment aboard is tailored for indulgence. Backed by a world-class crew, LADY FIRST is more than a yacht, it's an invitation to an unforgettable journey.

LADY FIRST



AERIAL VIEW



AERIAL VIEW



AERIAL VIEW



LADY FIRST

Main Deck

Aboard LADY FIRST, the main deck aft is an exquisite open-air retreat, offering alfresco dining for 12 and two elegant lounging areas. The seamless flow of the yacht's design continues along the side decks, leading to the bow lounge and upper deck. Stepping inside the main salon, guests are welcomed by plush, inviting sofas, a retractable TV, and floor-to-ceiling chrome-framed windows that bathe the space in natural light. The décor is a harmonious blend of modern sophistication and timeless luxury. Moving forward, the formal dining area showcases an Italian-designed glass table, encircled by opulent Fendi cowhide chairs for 12, creating a refined setting for exquisite meals. Just beyond, through the starboard walkway, the grandeur of the full-beam primary stateroom unfolds. This private sanctuary features a king-size bed, a serene lounge area, and a versatile study that seamlessly transforms into a vanity, offering both elegance and functionality in perfect balance.

LADY FIRST

Click the labels
to navigate to
the corresponding
pages.

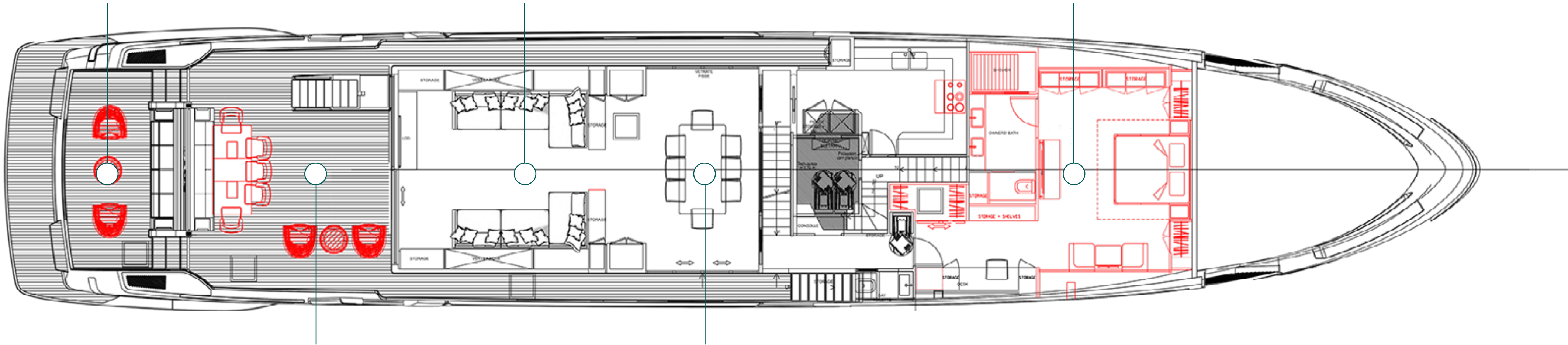



MAIN DECK | SWIM PLATFORM



MAIN DECK | SWIM PLATFORM



MAIN DECK | AFT DECK



MAIN DECK | AFT DECK



MAIN DECK | MAIN SALON



MAIN DECK | MAIN SALON



MAIN DECK | DINING AREA



MAIN DECK | GALLEY



MAIN DECK | PRIMARY STATEROOM OFFICE



MAIN DECK | PRIMARY STATEROOM





MAIN DECK | PRIMARY STATEROOM ENSUITE



LADY FIRST

Lower Deck

Nestled just below the main deck, the lower deck of M/Y LADY FIRST features four well-appointed guest staterooms, offering refined and spacious accommodations for up to nine guests. The layout includes three queen-bed staterooms and a versatile twin cabin with two convertible twin beds that can be joined to form a double. An additional Pullman berth in the twin cabin provides extra flexibility for accommodations. Each stateroom ensures privacy with an ensuite bathroom adorned with floor-to-ceiling marble accents—from sleek countertops and spacious showers to beautifully polished floors. Thoughtfully designed for both comfort and functionality, every stateroom features a high-definition TV, a dedicated vanity/workspace area, and wide windows that fill the space with natural light.

Click the labels
to navigate to
the corresponding
pages.

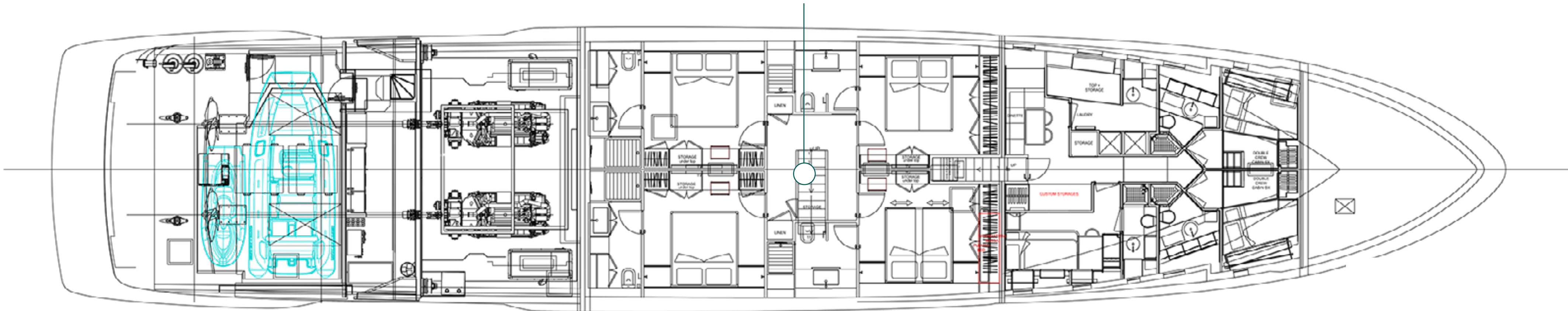



LOWER DECK | GUEST STATEROOM



LOWER DECK | GUEST STATEROOM ENSUITE



LOWER DECK | GUEST STATEROOM



LOWER DECK | GUEST STATEROOM ENSUITE



LOWER DECK | GUEST STATEROOM



LOWER DECK | GUEST STATEROOM ENSUITE



LOWER DECK | TWIN CABIN



LOWER DECK | TWIN CABIN ENSUITE



LADY FIRST

Upper Deck

LADY FIRST's upper deck aft offers two distinct alfresco spaces designed for both relaxation and social gatherings. A refined lounging area, complete with plush sofas and a coffee table, invites guests to unwind, while a spacious circular wooden dining table for 12 sets the scene for convivial meals beneath the open sky. Through automatic glass doors, the skylounge unveils an inviting retreat, an elegant yet relaxed setting where guests can watch TV, enjoy games, or take in breathtaking panoramic views. Forward, the bow deck presents another stunning escape, featuring a U-shaped lounge with a generous table ideal for afternoon tea or evening cocktails. Luxurious sun pads provide the perfect sun-kissed haven, offering front-row seats to the mesmerizing vistas of the open sea, best enjoyed while soaking in the forward bow jacuzzi.

LADY FIRST

Click the labels
to navigate to
the corresponding
pages.

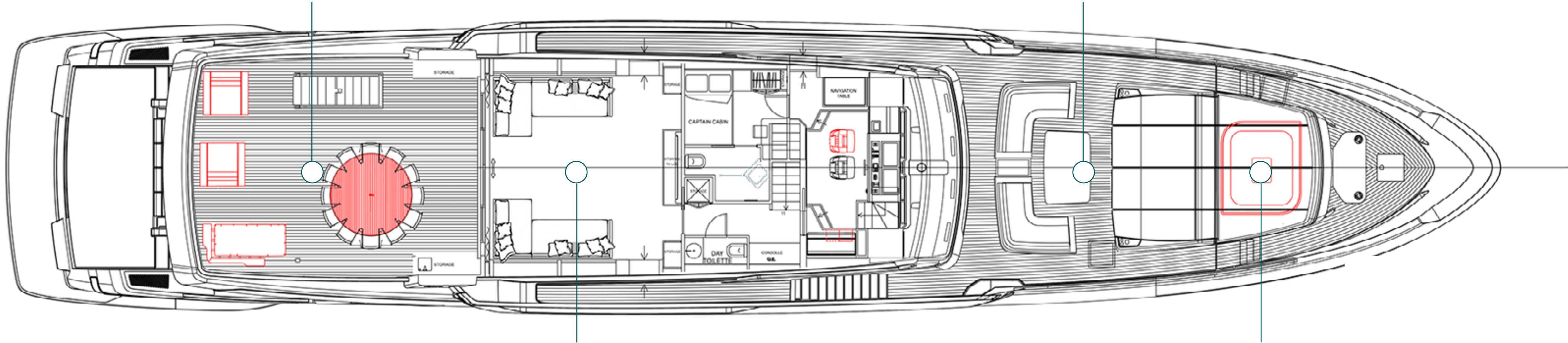



UPPER DECK | AFT DECK DINING



UPPER DECK | SKYLOUNGE



UPPER DECK | SKYLOUNGE



UPPER DECK | BOW LOUNGE



UPPER DECK | JACUZZI



LADY FIRST

Sun Deck

At the summit of LADY FIRST, the sundeck offers a haven of tranquility bathed in sunlight. Aft, inviting loungers provide an idyllic space to unwind; perfect for basking in the warmth of the day or gazing at the endless canopy of stars after dusk. Forward, the sundeck bar creates an intimate yet sophisticated atmosphere, complete with plush sofas, ottomans, and two elevated chairs that offer breathtaking views. Whether savoring a signature cocktail or simply taking in the open sea, guests can enjoy a front-row seat to the yacht's journey, embracing the ever-changing beauty of the horizon.

LADY FIRST

Click the labels
to navigate to
the corresponding
pages.

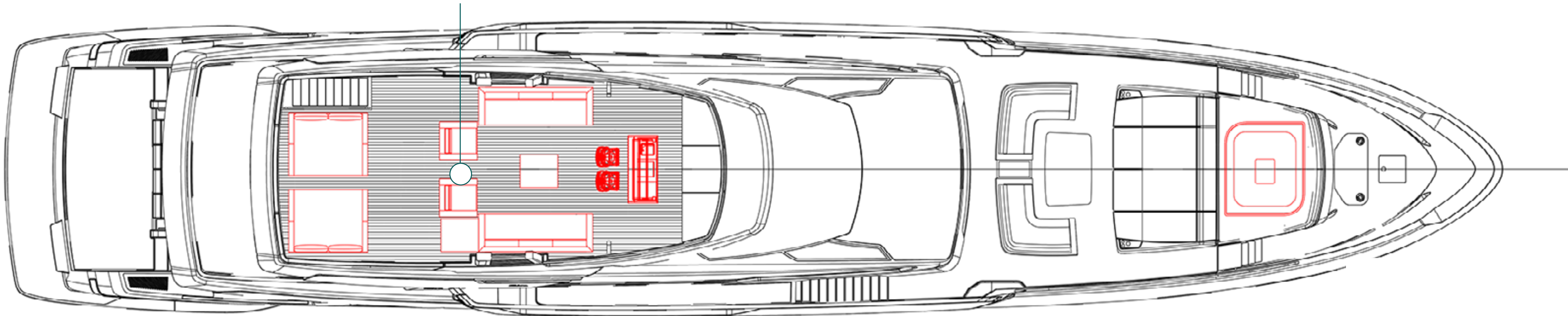



SUN DECK | LOUNGE VIEW FORWARD



SUN DECK | LOUNGE VIEW AFT



LADY FIRST

Tenders and Toys

Aboard LADY FIRST, adventure is always within reach with an exciting array of water toys designed for endless fun on the open sea. Speed across the waves with the powerful **Williams SportJet 520** or carve through the water on the **Seadoo jet ski**. For an electrifying ride, take the **eFoils** or **Seabobs** for a thrilling glide above and below the surface. Tow sports enthusiasts can enjoy wakeboarding, waterskiing, or the exhilarating **Jobe Binar towables**, perfect for both solo and group rides. For a more serene experience, paddle along secluded coves in the **kayaks** or **paddleboard**, or explore vibrant marine life with **snorkeling gear**. Whether seeking adrenaline-pumping action or tranquil moments on the water, LADY FIRST ensures every guest finds their perfect ocean escape.

LADY FIRST

Tenders & Toys



Tenders

5.2m (17ft) 2022 Williams SportJet 520w 230hp engine

Toys	Details
2x Efoil	-
2x Seabob	-
Seadoo jet ski	-
Wakebord	-
2x Jobe Binar Towable	1x4 seats, 1x1 seat
Waterski	Adult
2x Kayak	-
Paddleboard	-
Snorkeling gear	-
4x Pool Noodles	-



Specifications

Dimensions

Length	40m (131’)
Beam	7.86m (25’9”)
Draft	2.29m (7’6”)

General and Technical

Year	2023
Builder	Riva
Interior Designer	Officina Italiana Design
Naval Architect	Ferretti Engineering Department
Hull Construction	GRP
Hull Configuration	Semi-displacement
Engines	2 MTU 16V 2000 M96L (2x 2660hp)
Generators	2x Zenoro 80kW
Gross Tons	290
Cruising Speed	17 knots
Max Speed	22 knots

Accommodations

Total Crew	7
Total Guests	11
Total Cabins	5
Bed Configuration	4 King Beds, 2 Single Beds (Convertible to King), 1 Pullman

Special Features

Meticulously maintained and previously used exclusively for private enjoyment before being introduced to the charter market.

Spacious and comfortable living areas with high ceilings and a wide beam.

Large swim platform and a generously sized sundeck offering ample alfresco entertainment spaces with room for lounging and direct access to the water.

Private terrace at the bow, featuring a jacuzzi, lounge area, and sun pad, for exclusive relaxation.

Great collection of water toys, providing endless fun and adventure on the water.

State-of-the-art navigation and entertainment technology, ensuring smooth sailing and an exceptional onboard experience.

Highly professional and attentive crew delivering personalized service, ensuring every aspect of the charter experience is tailored to guests’ desires.

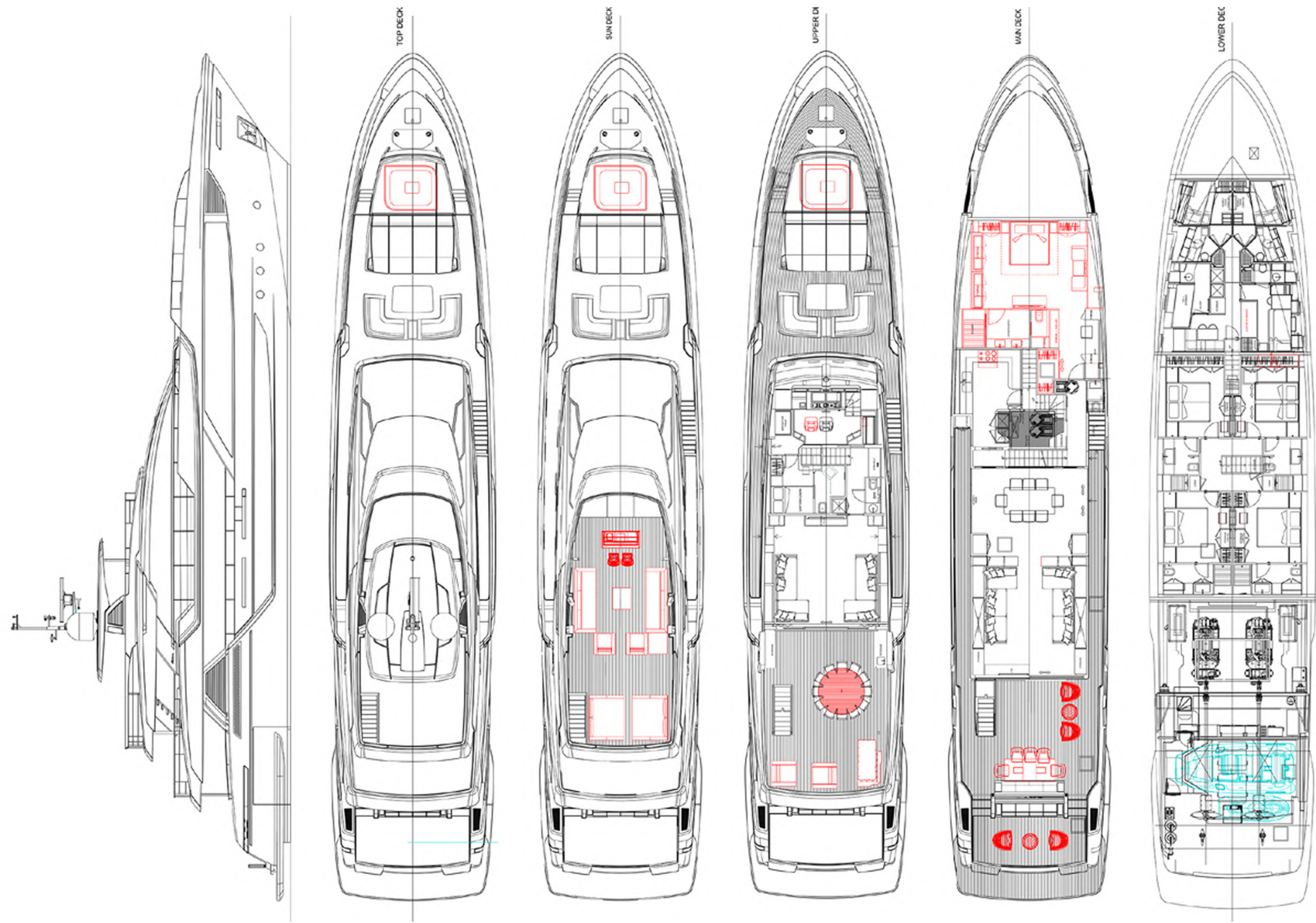



This document is for information purposes only and is not meant to be contractual. The company provides all details and images in good faith and makes every effort to keep information accurate and up to date. However, accuracy, completeness, and reliability cannot always be guaranteed. Yacht specifications, availability, and crew may change at any time without notice. No part of this document may be copied or reproduced without the company's prior written consent.