



NIGHTFLOWER

BUILDER: CODECASA

LENGTH: 35 MT

YEAR: 1987

CABINS: 5



NIGHTFLOWER

CODECASA



NIGHTFLOWER

CODECASA



NIGHTFLOWER

CODECASA



NIGHTFLOWER

CODECASA



NIGHTFLOWER

CODECASA



NIGHTFLOWER

CODECASA



NIGHTFLOWER

CODECASA



NIGHTFLOWER

CODECASA



NIGHTFLOWER

CODECASA



NIGHTFLOWER

CODECASA



NIGHTFLOWER

CODECASA



NIGHTFLOWER

CODECASA



NIGHTFLOWER

CODECASA



NIGHTFLOWER

CODECASA



NIGHTFLOWER

CODECASA



NIGHTFLOWER

CODECASA



NIGHTFLOWER

CODECASA



NIGHTFLOWER

CODECASA



NIGHTFLOWER

CODECASA



NIGHTFLOWER

CODECASA



NIGHTFLOWER

CODECASA



NIGHTFLOWER

CODECASA



NIGHTFLOWER

CODECASA



NIGHTFLOWER

CODECASA



NIGHTFLOWER

CODECASA



NIGHTFLOWER

CODECASA



NIGHTFLOWER

CODECASA



NIGHTFLOWER

CODECASA



NIGHTFLOWER

CODECASA



NIGHTFLOWER

CODECASA



NIGHTFLOWER

CODECASA



NIGHTFLOWER

CODECASA



NIGHTFLOWER

CODECASA



NIGHTFLOWER

CODECASA



NIGHTFLOWER

CODECASA



NIGHTFLOWER

CODECASA



NIGHTFLOWER

CODECASA



NIGHTFLOWER

CODECASA



NIGHTFLOWER

CODECASA



NIGHTFLOWER

CODECASA



NIGHTFLOWER

CODECASA



NIGHTFLOWER

CODECASA



NIGHTFLOWER

CODECASA



NIGHTFLOWER

CODECASA



NIGHTFLOWER

CODECASA



NIGHTFLOWER

CODECASA



NIGHTFLOWER

CODECASA



NIGHTFLOWER

CODECASA



NIGHTFLOWER

CODECASA



NIGHTFLOWER

CODECASA



NIGHTFLOWER

CODECASA



NIGHTFLOWER

CODECASA



NIGHTFLOWER

CODECASA



NIGHTFLOWER

CODECASA



NIGHTFLOWER

CODECASA



NIGHTFLOWER

CODECASA



NIGHTFLOWER

CODECASA

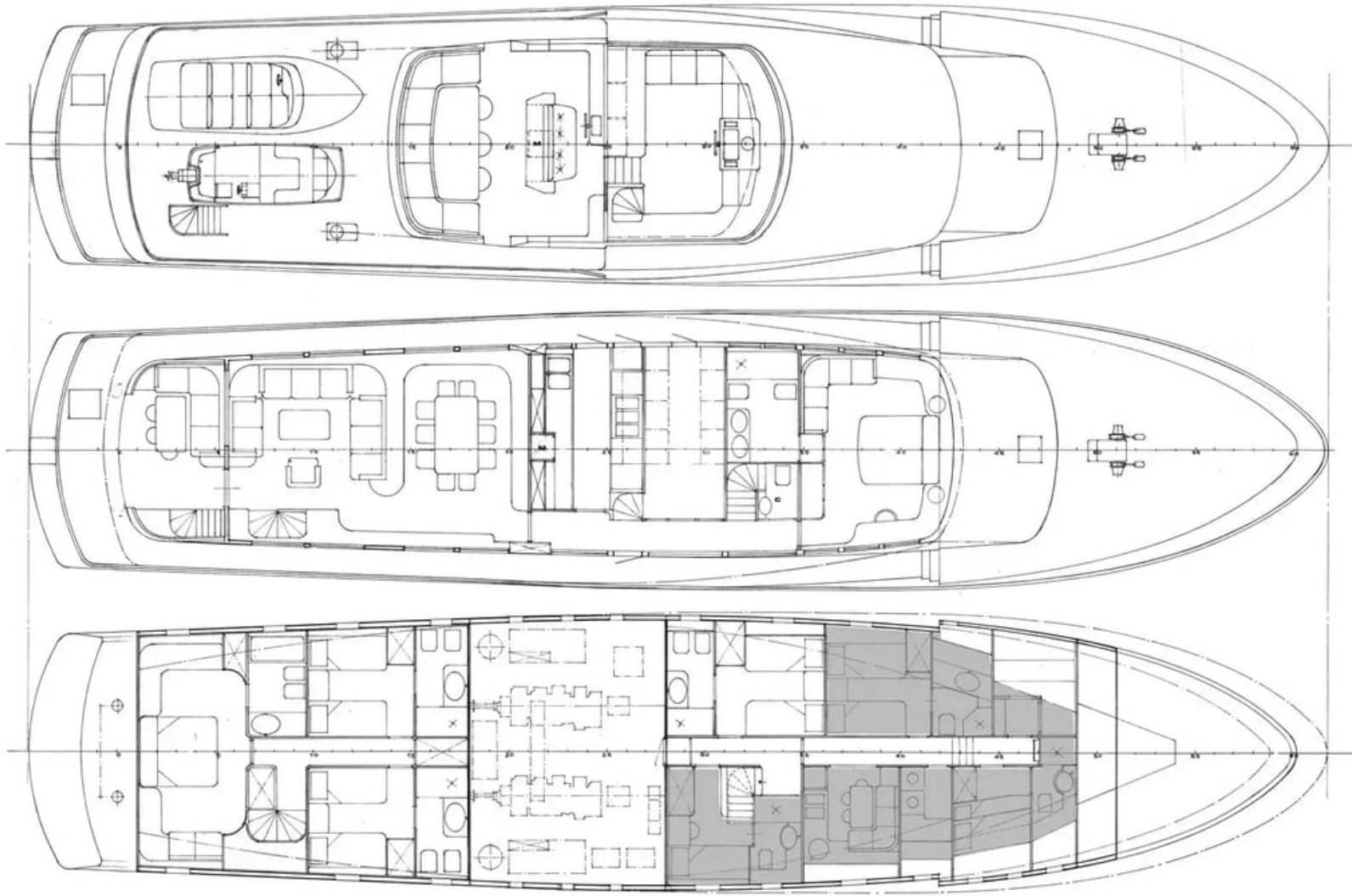

NIGHTFLOWER

CODECASA



NIGHTFLOWER

CODECASA

NIGHTFLOWER is an elegant Codecasa 35, entirely crafted from steel in 1987 and has been meticulously maintained in impeccable condition through substantial refits, the latest of which was completed in 2022. Thanks to her displacement hull with a deep keel, she is a perfect vessel for extended ocean voyages and spending nights at anchor.

The yacht offers accommodation for up to 10 guests in 5 cabins. The Master cabin, located on the main deck, is equally spacious as the VIP cabin, situated on the lower deck aft. Both of these cabins feature King-size beds, ample wardrobe space, and particularly spacious en-suite bathrooms. Additionally, there are 3 twin cabins, each with single beds and their own en-suite bathrooms. Two of these cabins are positioned at the stern, while one is located in the forward area and is accessible via a separate staircase. All cabins are equipped with air conditioning and Smart TVs for the guests' comfort.

What sets NIGHTFLOWER apart are her expansive outdoor areas. The flybridge boasts a shaded section with a large dining table and a roomy sunbathing area, which can conveniently transform into a yoga and exercise space as needed. The aft cockpit offers a relaxing setting with a table and comfortable seating for conversation. On the bow, there's a spacious sunbathing area, easily accessible via a separate staircase.

The professional crew is composed of 7 individuals, each with a wealth of experience, and many have been working in the yachting industry for numerous years.

TECHNICAL SPECIFICATIONS

LENGTH	35 mt
REFIT	2022
BEAM	7.01 mt
ENGINES	2 x CAT 624 HP, 2 x Generators 55 KW + 1 X 35 KW
CRUISING SPEED	11 knots
FUEL CONSUMPTION	140 Litres/Hr
CABINS	2 Double, 3 Twin
GUESTS	10 sleeping - 10 cruising
CREW	Captain + 6
TENDER + TOYS	· 1 SACS 5,60m 70 HP · 1 ZAR FORMENTI 3,80 20 HP · 1 JetSki Seadoo 3 seats (License required) · 2 Canoes · Tubes · Water ski · Snorkeling Equipment · Wakeboard · Paddle Board
BASE PORT	Naples

NIGHTFLOWER

CODECASA