

AMARYLLIS



78.43m (257' 4") | Abeking & Rasmussen | 2011





Main Salon



Forward Salon



Piano Lounge





Dining



Master Stateroom Office



Master Stateroom



Master En Suite - His



Master En Suite - Hers



Master Private Deck



VIP Stateroom



VIP En Suite



Double Stateroom



En Suite Guest



Double Stateroom



Double Stateroom



Twin Stateroom



Bridge



Elevator & Staircase



Bridge Deck - Dining



Sun Deck - Forward



Upper Deck



Jacuzzi Pool

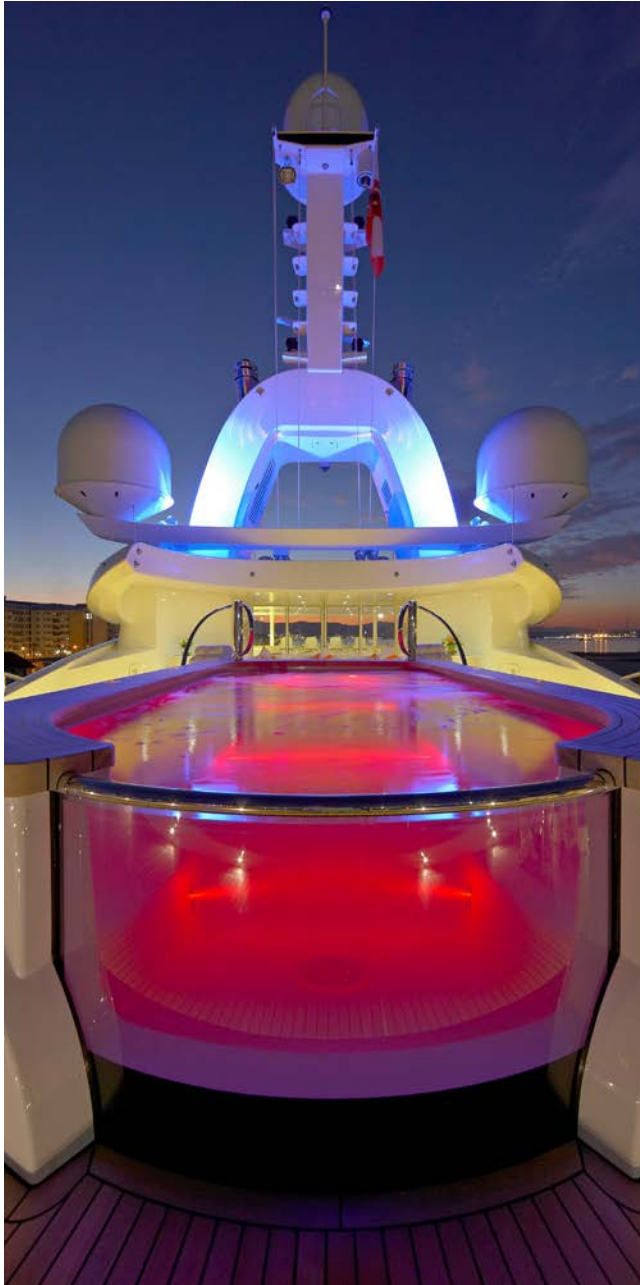

AMARYLLIS

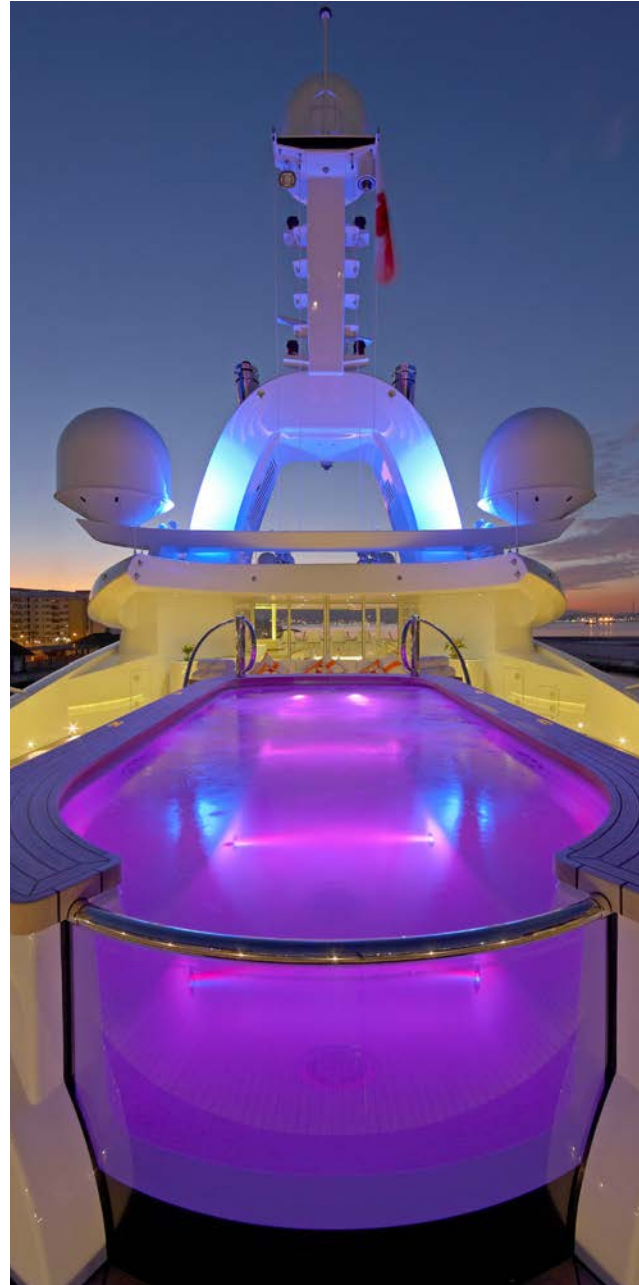

26

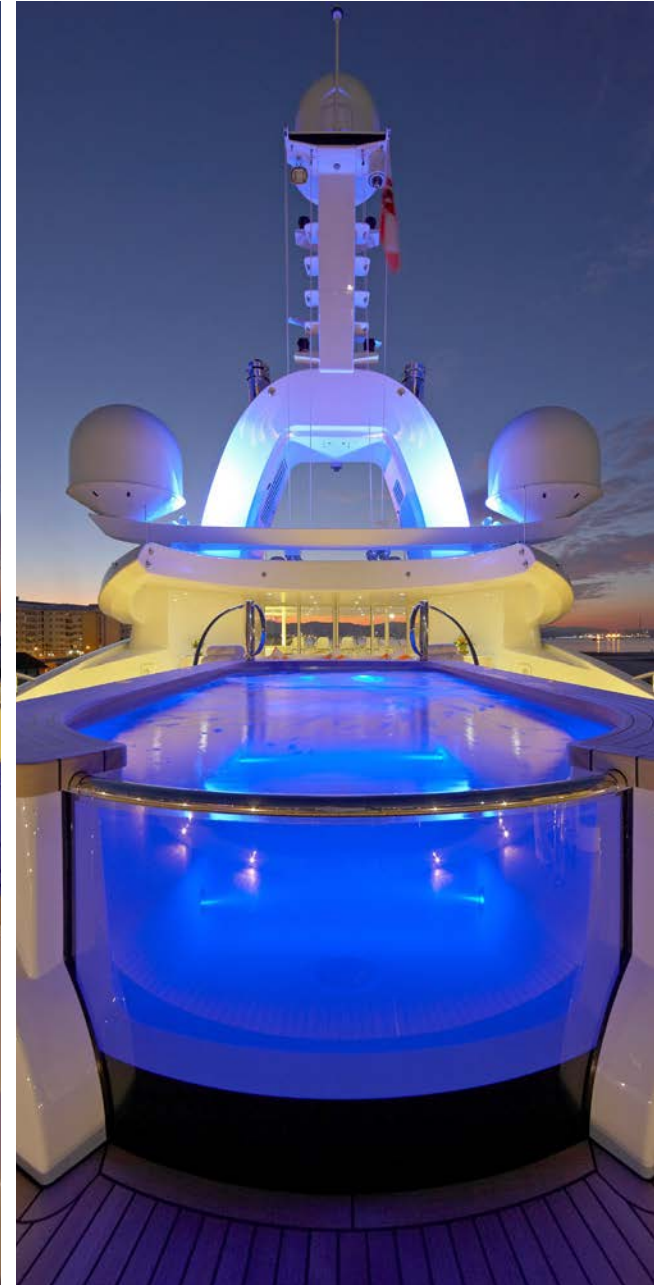

Abeking & Rasmussen



Beach Club



Massage Area



Gym



Spa



Sauna



Steam Room



Graf Tender



Toys

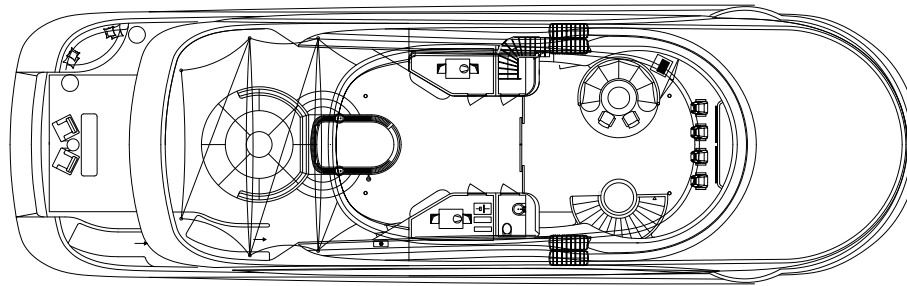

Sun Deck

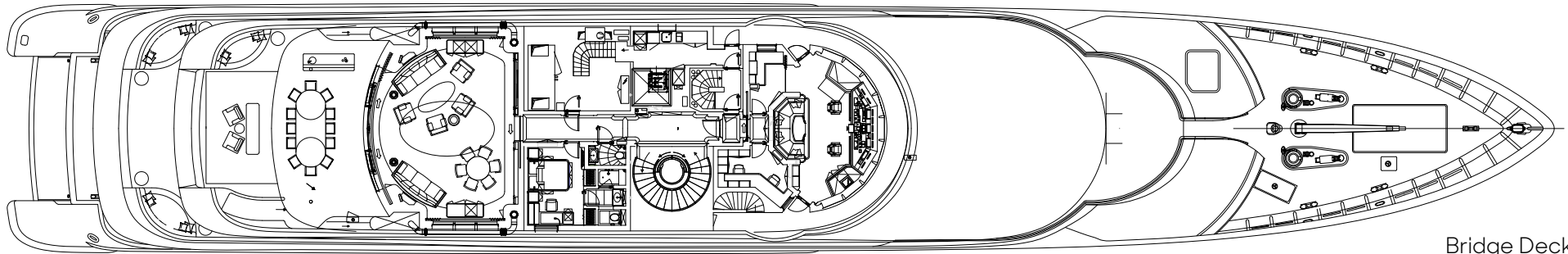

Bridge Deck

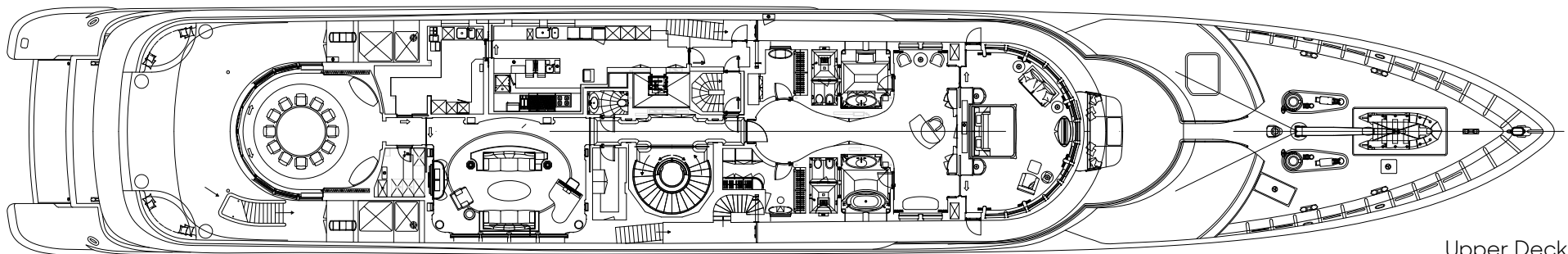

Upper Deck

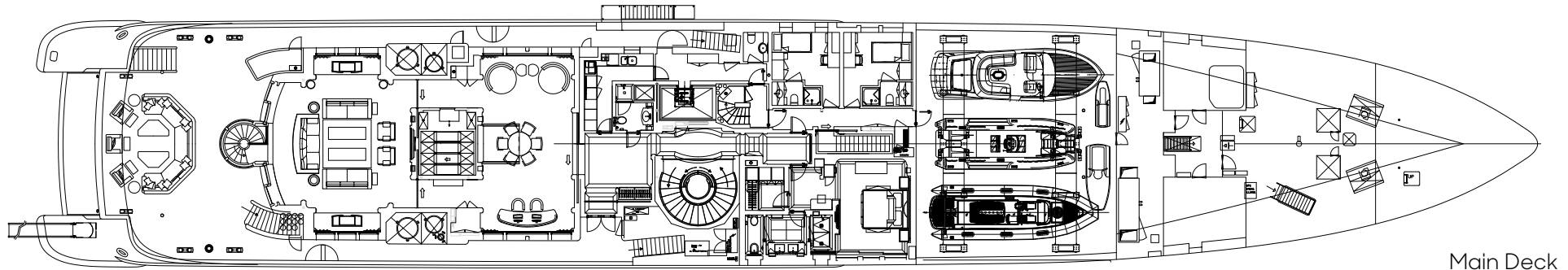

Main Deck

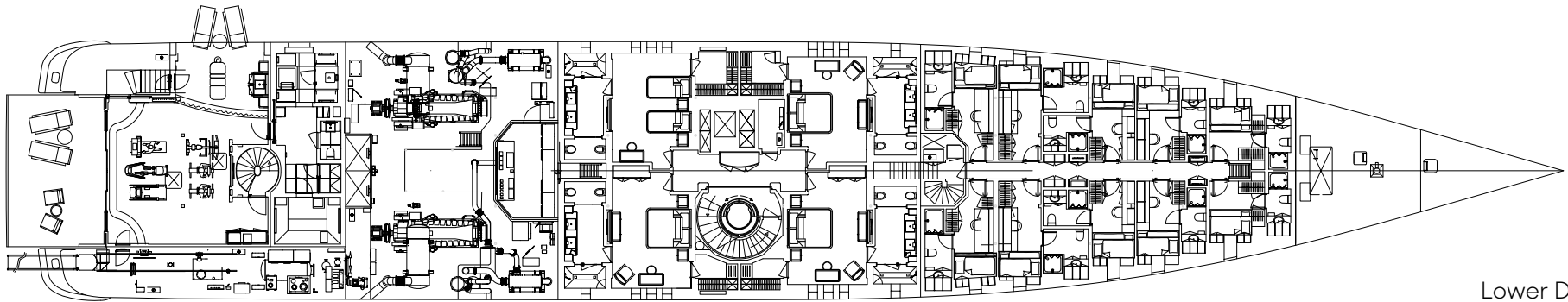

Lower Deck

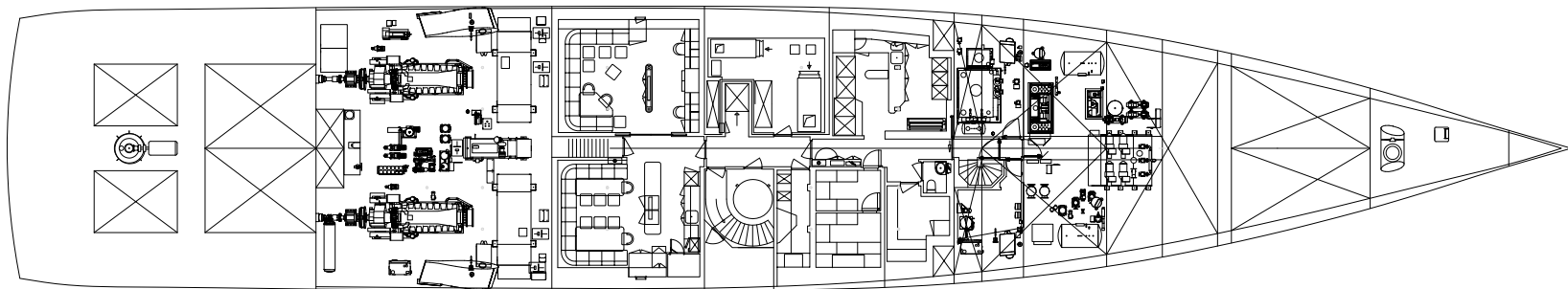

Tank Deck

SPECIFICATIONS

DIMENSIONS

Length	78.43m (257' 4")
Beam	12.4m (40' 7")
Draft	3.45m (11' 3")

GENERAL

Year	2011
Builder	Abeking & Rasmussen
Naval Architect	Abeking & Rasmussen
Interior Design	Reymond Langton
Exterior Design	Reymond Langton
Hull Construction	Steel

ACCOMMODATION

Number of Cabins	1 King, 3 Queens, 2 Twins (1 convertible Queen)
Total Guests	12
Total Crew	23

CERTIFICATIONS

Flag	Cayman Islands
Port of Registry	George Town
Class / MCA	Commercial / MCA / ISM / ISPS

TECHNICAL INFORMATION

Engines	2 x Caterpillar 3516 DITA (2,000 hp) - 4,000 hp
Fuel Consumption	550 Litres / hr
Cruising Speed	14 knots
Maximum Speed	16 knots
Range	5000 nm

TENDERS

- 32' (9.9m) Graf Ipanema custom wooden tender with Volvo 370hp
- 22' 6" (6.9m) Malibu Wakesetter 20 VTX with Malibu Monsoon M6Di 430hp
- 28' 10" (8.8m) Pascoe Beach lander with Volvo 370hp
- 13' 7" (4.2m) Ribo 420 SOLAS approved rescue boat with Yamaha 25hp outboard

TOYS

- Inflatable Water Slide
- 2 x Seabob F5S underwater scooters
- Yamaha FZS 3 Person Waverunner
- Yamaha FB 1800A Waverunner
- Yamaha Super Jet Stand-up jet ski
- 2 x E foil Electric Board
- Wakeboards
- Water-ski's
- Inflatable water toys - Assortment
- Fishing equipment
- BBQ

AUDIO VISUAL EQUIPMENT

- Kaleidescape VOD
- Satellite TV
- iPod docking stations
- Crestron controls

OTHER

- At anchor stabilizers
- RYA Training Center
- Asian spa with plunge pool, sauna, steam room, massage area and gym
- Private terrace off the master stateroom
- Elevator
- WiFi throughout
- Air conditioning

WEEKLY CHARTER RATES - MYBA TERMS

Summer €770,000 Low Season / €875,000 High Season per week, plus all expenses
Winter \$770,000 Low Season / \$875,000 High Season per week, plus all expenses

